



- ▶ Centre hinge 625 is particularly suitable for use with folding doors
- ▶ Favourable running properties due to abrasion-resistant distance rings with swivel bearing
- ▶ With fixed steel pin
- ▶ Steel

**Centre hinge 625**

Finish	Order no.	PU
Nickel-plated	0 071 648	1/10 ea.

**Drilling pattern**

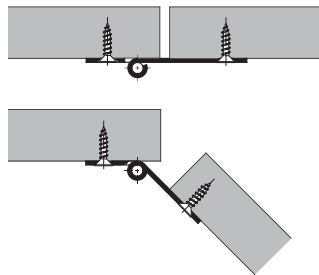
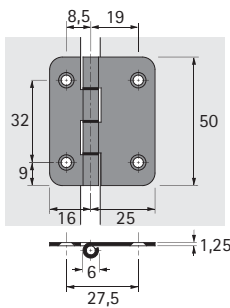

**Mounting with pivot offset**

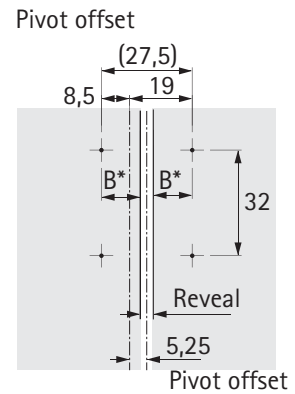

**Calculation of the pivot offset for folding doors**

**Mounting with pivot offset**

* B Hole spacing mm	11.25	11.75	12.25	12.75	13.25
Reveal mm	5	4	3	2	1

\* Make trial mounting

- 1) Mount 1st door half with 110° hinges on carcase and adjust reveal
- 2) Mount 2nd door half with running and guide elements on the running and guide profile and adjust the reveal (oblong holes in the running and guide elements)
- 3) Push the 1st and 2nd door halves together in open position (see diagram)
- 4) Measure value X at the outer edges of the door
- 5) Value L equals the required clearance
- 6) Half the door offset (value X) plus half the clearance (value L) equals the pivot offset

Secured with countersunk fixing screws  $\varnothing$  3.5 mm

**Mounting note**

