

# WingLine S

## de Montageanleitung

Falttürsystem

## cz Montážní návod

Kování pro skládané dveře

## dk Monteringsvejledning

Foldelågesystem

## es Instrucciones de montaje

Sistema de puertas plegable

## fr Instructions de montage

Système de portes pliantes

## fi Asennusohje

Taitto-ovijärjestelmä

## en Installation instructions

Folding door system

## it Istruzioni di montaggio

Sistema per ante a libro

## nl Montagehandleiding

Vouwdeursysteem

## pl Instrukcja montażu

System drzwi składanych

## ru Инструкция по монтажу

Система фурнитуры для складных дверей

## se Monteringsanvisning

Vikdörrssystem

## tr Montaj kılavuzu

Katlanır kapak sistemi

## kr 설치 설명서

폴딩 도어 시스템

## jp 金具取付けマニュアル

折れ戸システム

Technik für Möbel

**Hettich**



9 283 117

9 283 230

9 283 234

9 283 236

9 283 239

9 283 240

9 283 243

9 283 248

9 283 261

9 283 262

9 283 264



2 - 3



4

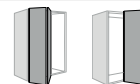

5- 10



10- 12



12 -14

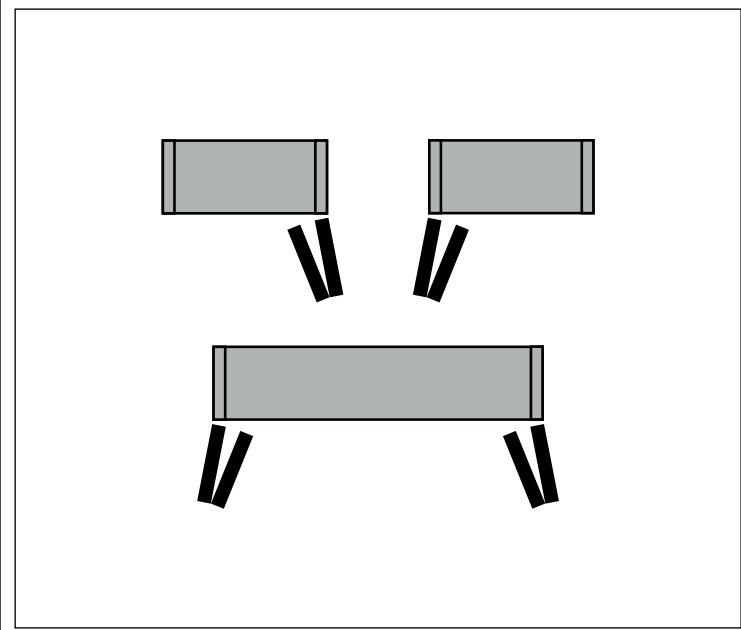
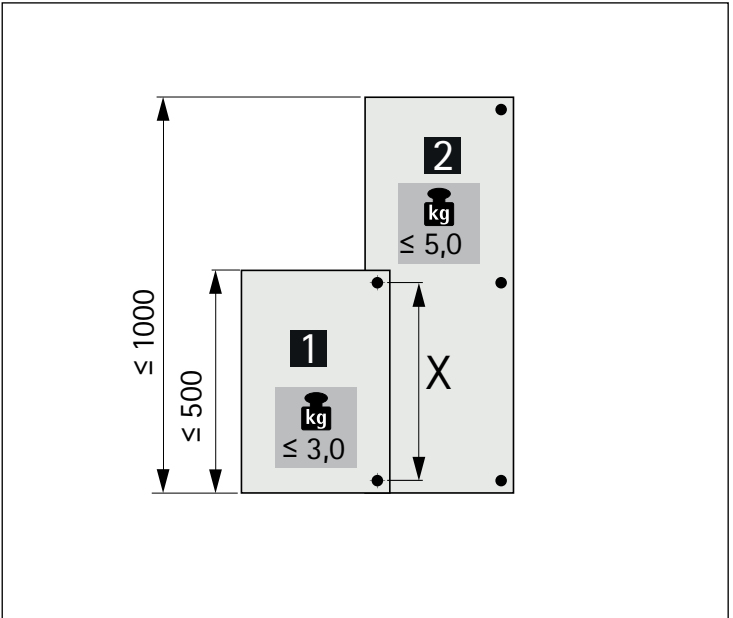
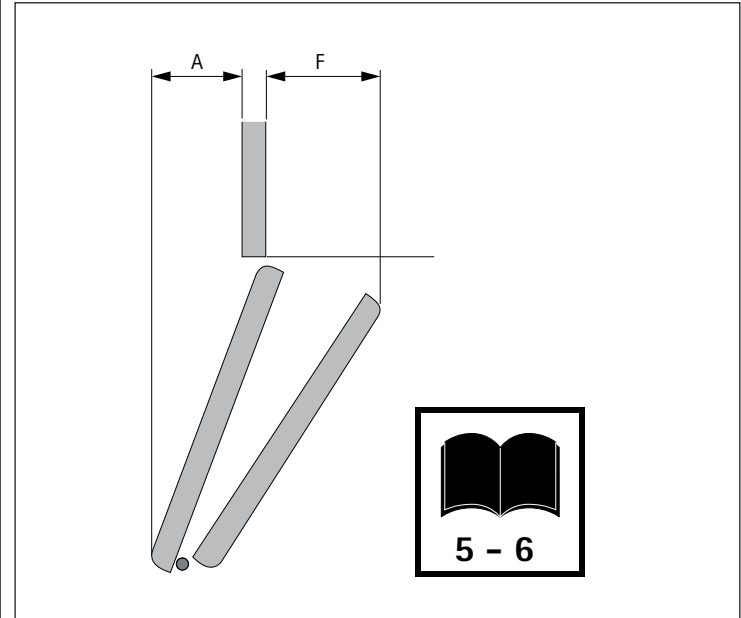
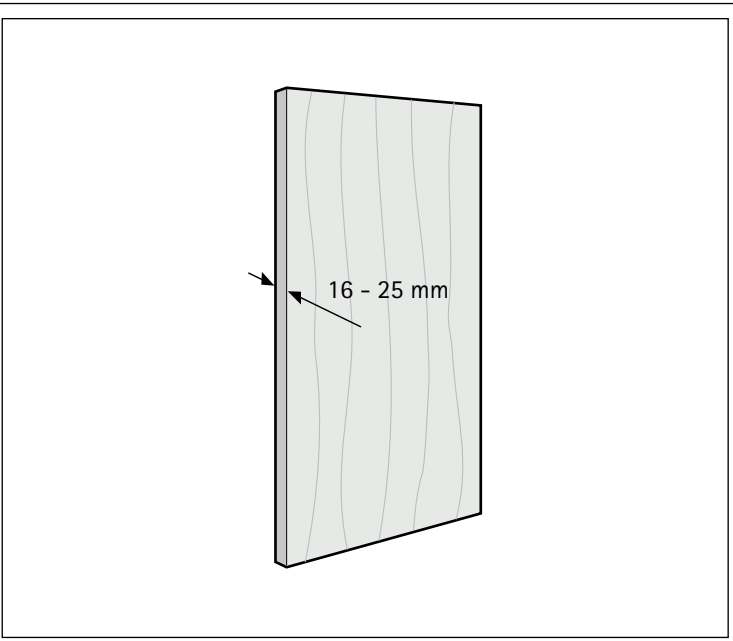
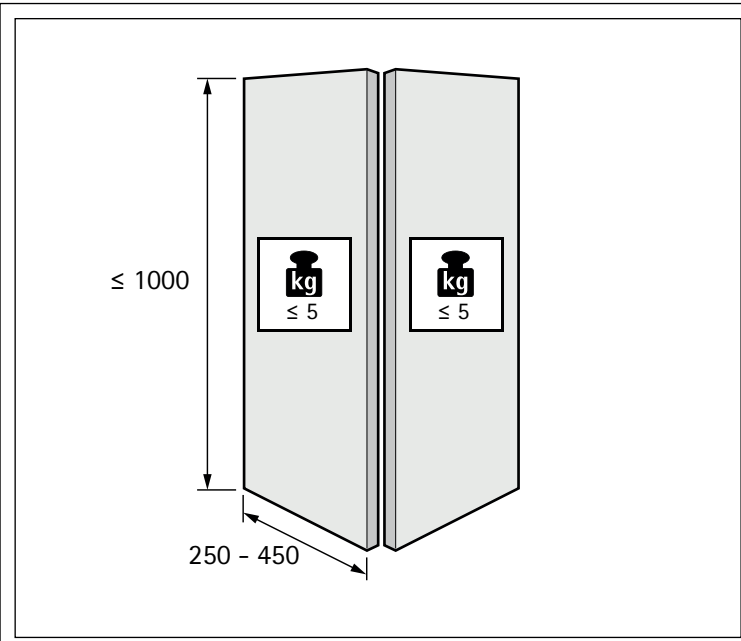

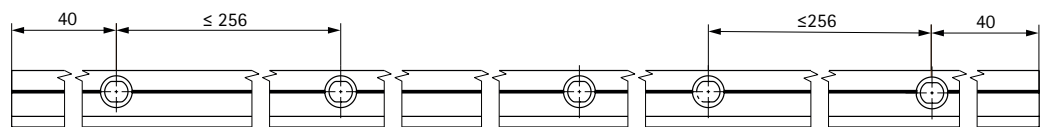
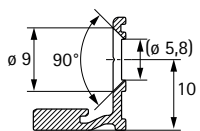
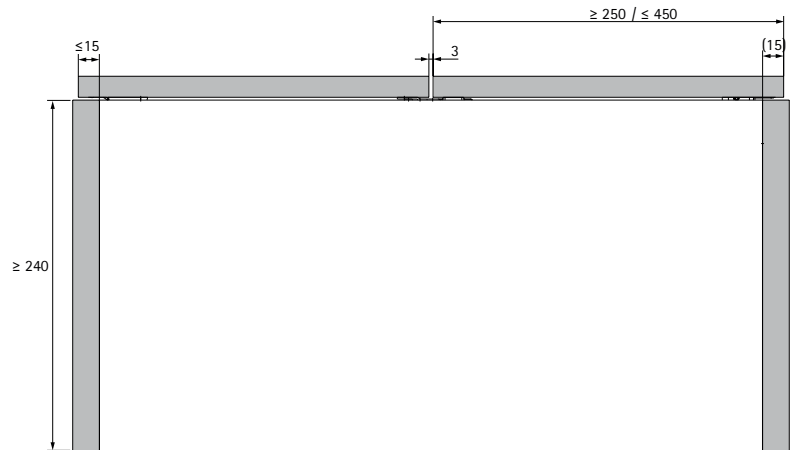
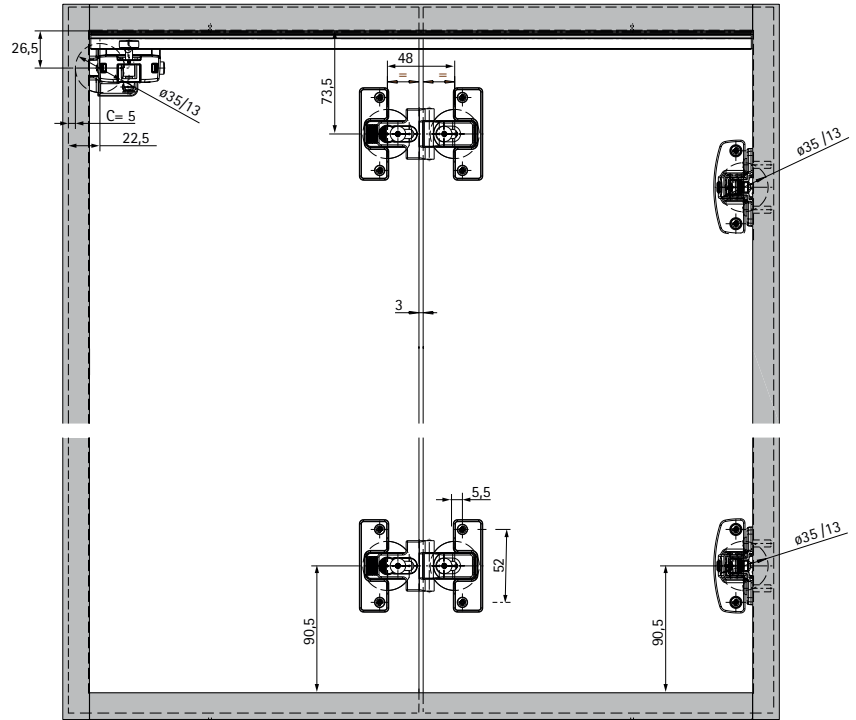
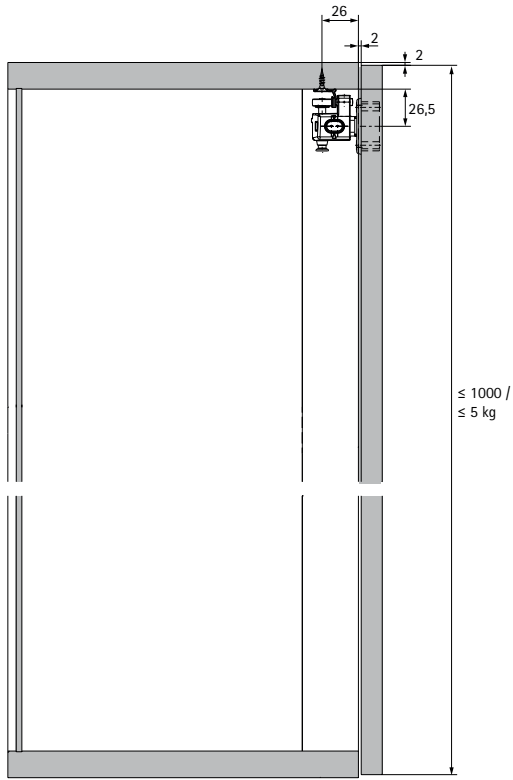

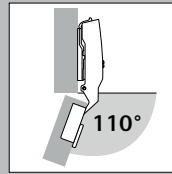
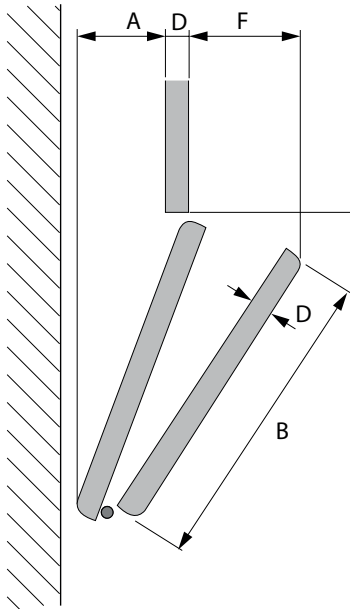
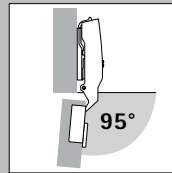
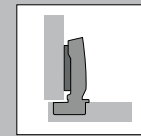
 Sensys  
8645i / 8675

 Sensys  
8631i / 8631 \*

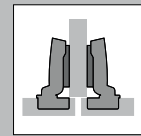
B 12,5



B 3

D	B	B 12,5		B 3	
		A	F	A	F
16	250	31	58	21	68
	300	41	58	32	68
	450	73	58	63	68
18 / 19	250	31	61	21	71
	300	41	61	32	71
	450	73	61	63	71
22	250	31	64	21	74
	300	41	64	32	74
	450	73	64	63	74
25	250	31	67	21	77
	300	41	67	32	77
	450	73	67	63	77
16	250	13	70	4	79
	300	18	72	8	82
	450	31	78	21	87
18 / 19	250	13	73	4	82
	300	18	75	8	84
	450	31	81	21	90
22	250	13	74	4	85
	300	18	78	8	87
	450	31	84	21	93
25	250	13	78	4	88
	300	18	81	8	90
	450	31	86	21	96

**de** \* Einschränkung der Öffnungsdämpfung bei reduzierten Öffnungswinkeln von 95°, 90° und 85°.

**cz** \* Omezení tlumení při otvírání s redukováným úhlem otevření 95°, 90° a 85°.

**dk** \* Begrænsning af åbningsdæmpning ved reducerede åbningsvinkler på 95°, 90° og 85°.

**es** \* Limitación de amortiguación de apertura con ángulos de apertura reducidos de 95°, 90° y 85°.

**fr** \* Limitation de l'amortisseur d'ouverture en cas d'angles d'ouverture réduits de 95°, 90° et 85°.

**fi** \* Avausvaimennus laskee jos avauskulma rajoitetaan 95°, 90° ja 85°.

**en** \* Soft opening is restricted at reduced opening angles of 95°, 90° and 85°.

**it** \* Limitazione dell'ammortizzatore in apertura per angoli di apertura ridotti di 95°, 90° e 85°.

**nl** \* Beperking van de openingsdemping bij gereduceerde openingshoeken van 95°, 90° en 85°.

**pl** \* Ograniczenie tłumienia otwarcia przy zmniejszonych kątach otwarcia wynoszących 95°, 90° oraz 85°.

**ru** \* Ограничение демпфирования при уменьшении угла открывания 95°, 90° и 85°.

**se** \* Minskning av öppningsdämpningen vid reducerad öppningsvinkel om 95°, 90° och 85°.

**tr** \* 95°, 90° ve 85° açılma açılarında, kapak açma hareketinin kısıtlanması.

**kr** \* 소프트 오프닝은 열림각도 95°, 90° 그리고 85°로 제한됩니다.

**jp** \* 開き角度は、95°、90°、85°と制限できます。

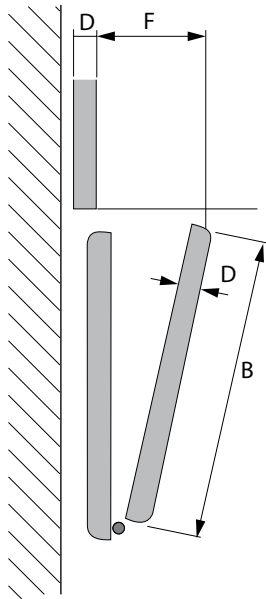

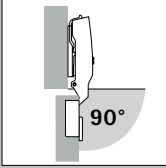
	D	B	B 12,5		B 3	
			F	F	F	F
 <b>Sensys 8645i / 8675*</b>	16	250	89	99		
		300	95	105		
		450	111	120		
	18 / 19	250	92	102		
		300	98	108		
		450	113	123		
	22	250	95	105		
		300	101	111		
		450	116	126		
	25	250	98	108		
		300	104	114		
		450	119	129		

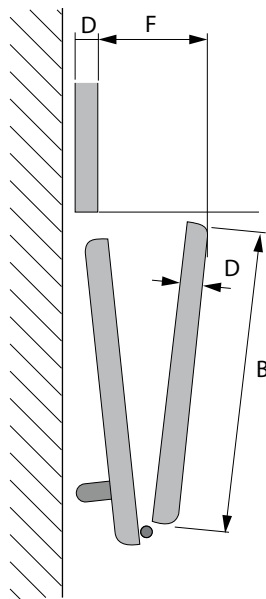

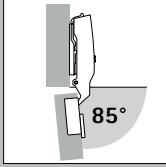
	D	B	B 12,5		B 3	
			F	F	F	F
 <b>Sensys 8645i / 8675*</b>	16	250	115	125		
		300	127	136		
		450	159	169		
	18 / 19	250	118	128		
		300	130	139		
		450	162	172		
	22	250	121	131		
		300	133	142		
		450	165	175		
	25	250	124	133		
		300	136	145		
		450	168	178		

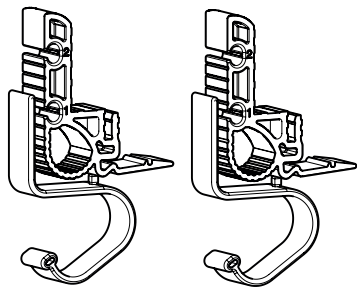
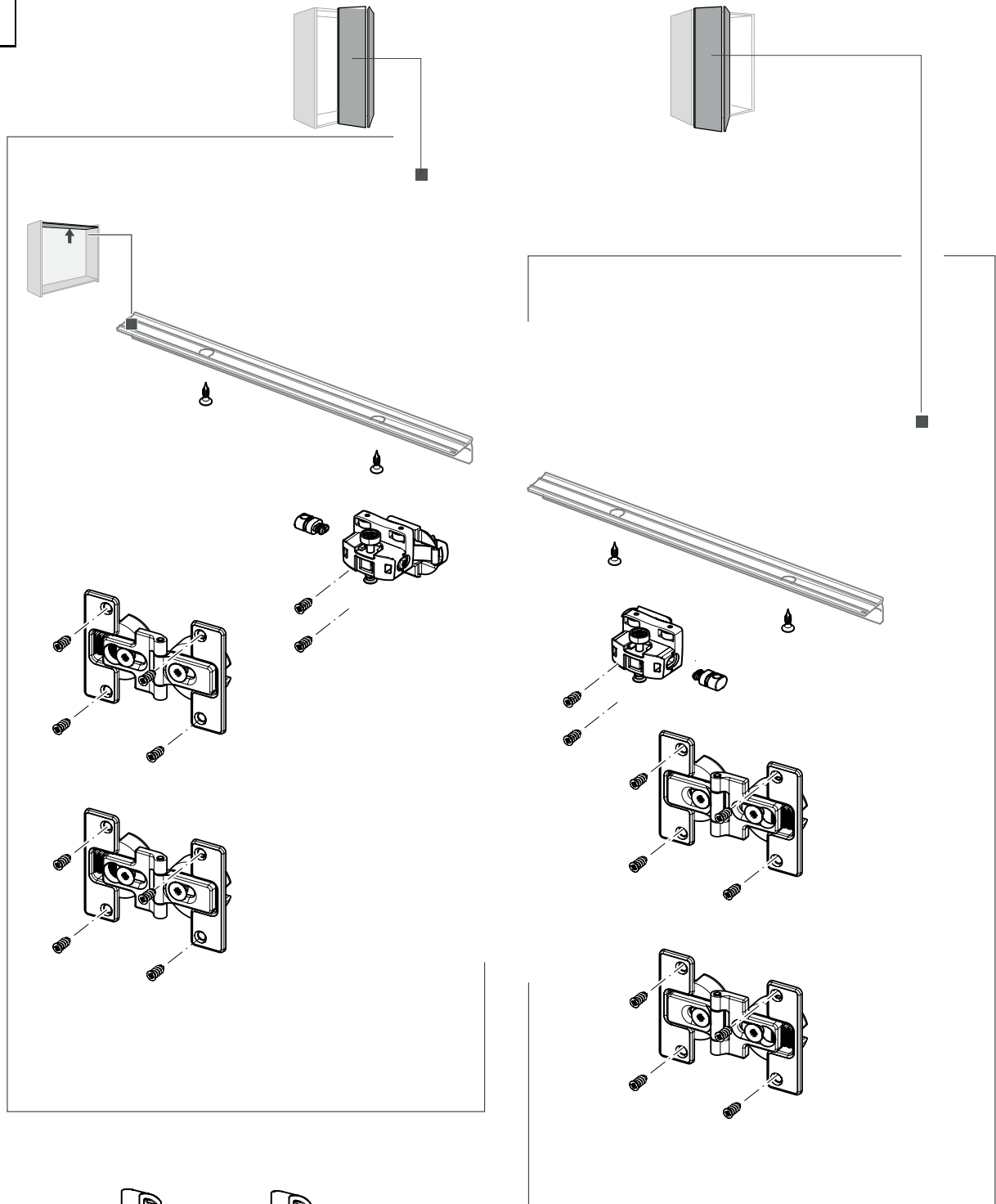

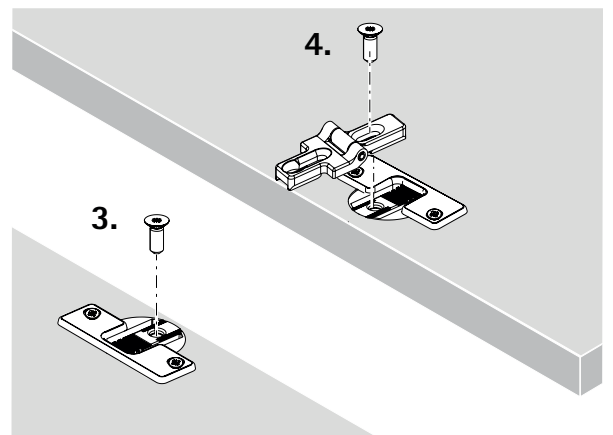
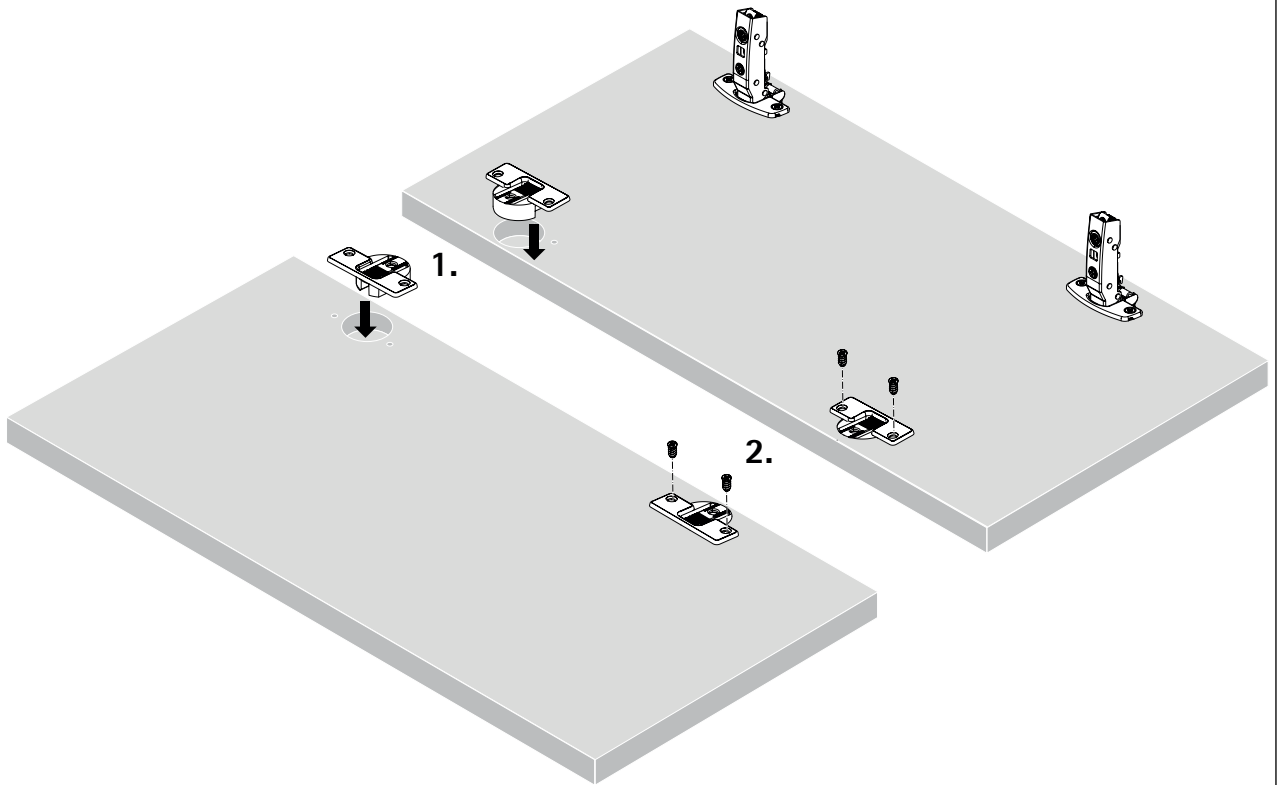
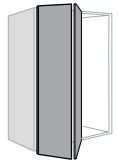
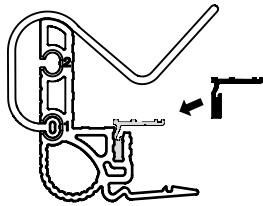
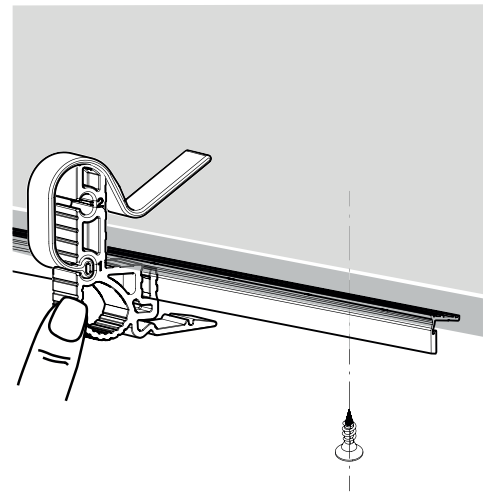
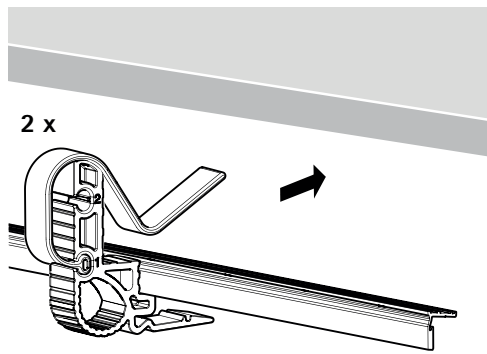
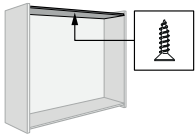

**i**

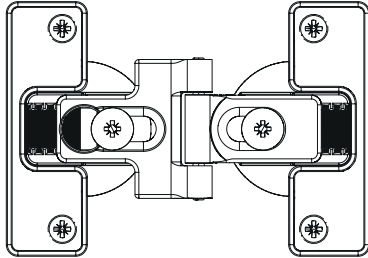
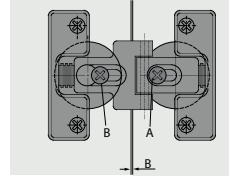
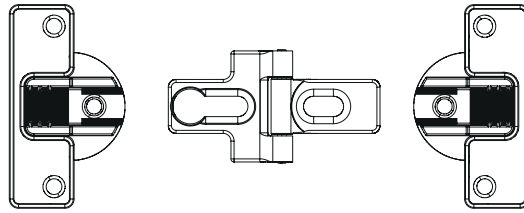

A = 0

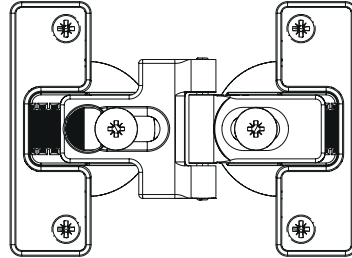

A = 3

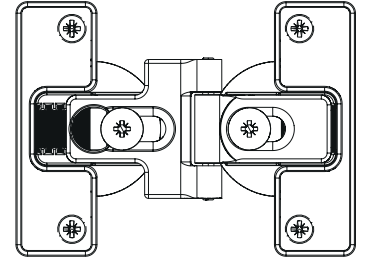

A = 6

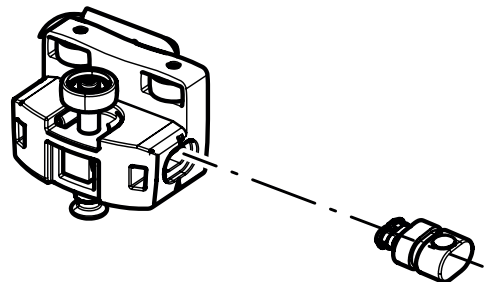
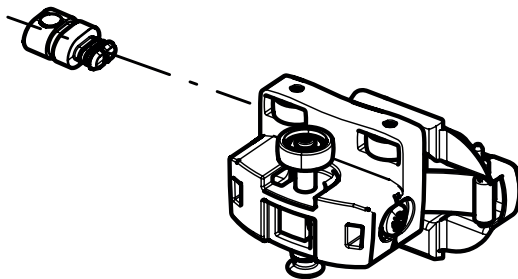
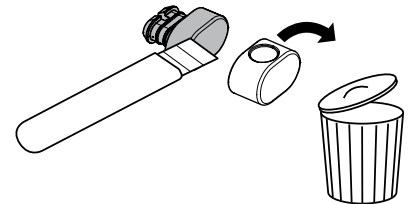
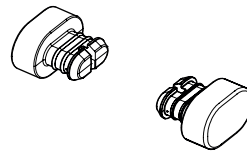
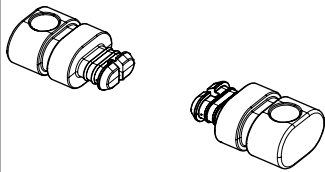
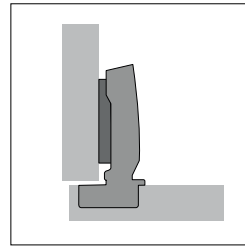
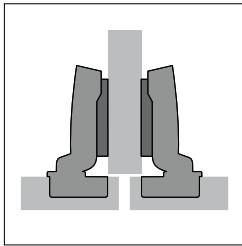





- ▶ Centre hinge 625 is particularly suitable for use with folding doors
- ▶ Favourable running properties due to abrasion-resistant distance rings with swivel bearing
- ▶ With fixed steel pin
- ▶ Steel

**Centre hinge 625**

Finish	Order no.	PU
Nickel-plated	0 071 648	1/10 ea.

**Drilling pattern**

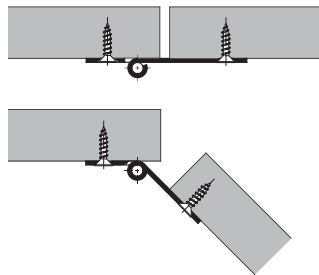
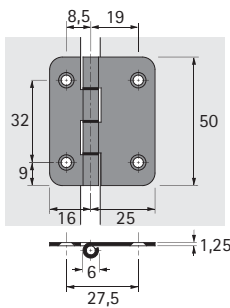

**Mounting with pivot offset**

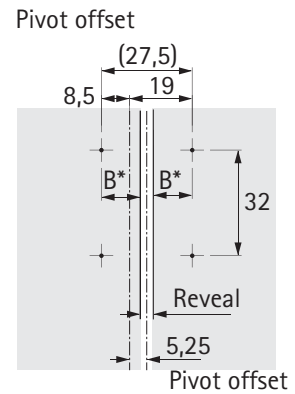

**Calculation of the pivot offset for folding doors**

**Mounting with pivot offset**

* B Hole spacing mm	11.25	11.75	12.25	12.75	13.25
Reveal mm	5	4	3	2	1

\* Make trial mounting

- 1) Mount 1st door half with 110° hinges on carcase and adjust reveal
- 2) Mount 2nd door half with running and guide elements on the running and guide profile and adjust the reveal (oblong holes in the running and guide elements)
- 3) Push the 1st and 2nd door halves together in open position (see diagram)
- 4) Measure value X at the outer edges of the door
- 5) Value L equals the required clearance
- 6) Half the door offset (value X) plus half the clearance (value L) equals the pivot offset

Secured with countersunk fixing screws  $\varnothing$  3.5 mm

**Mounting note**

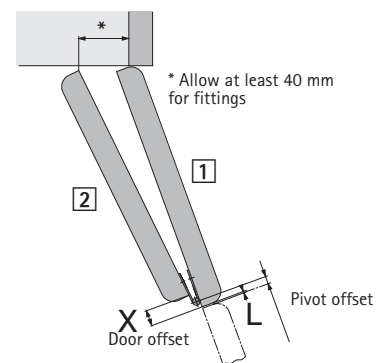

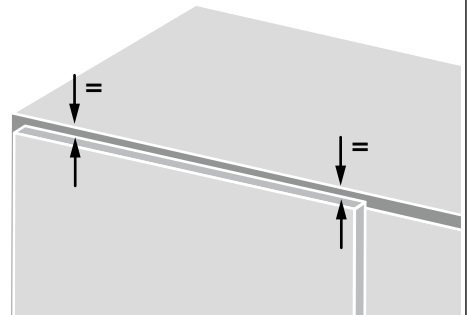
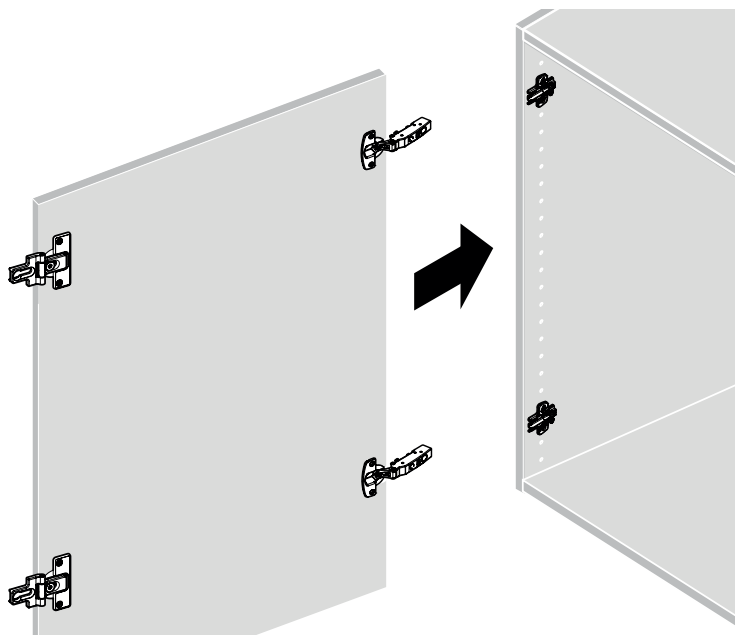
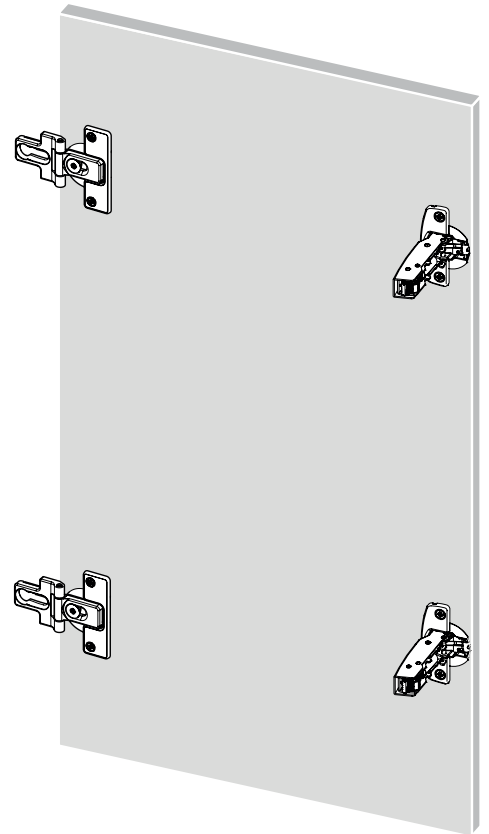
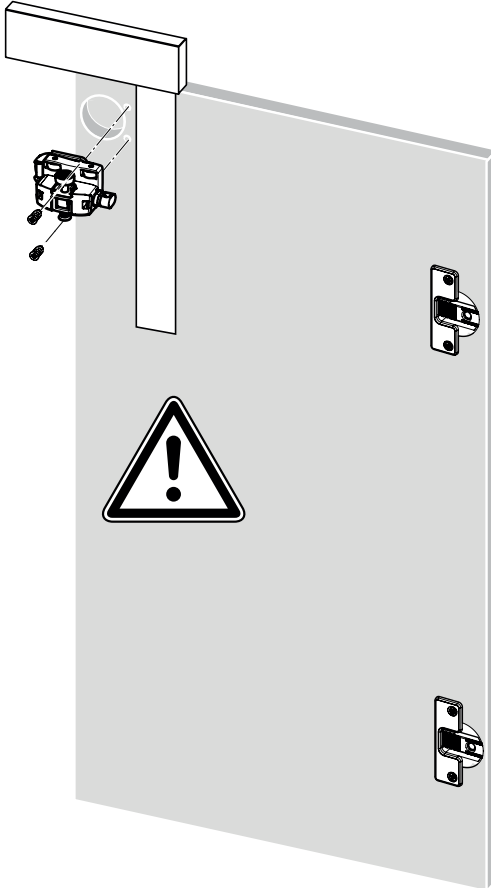
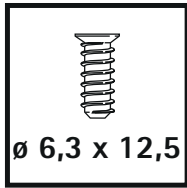
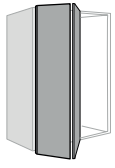

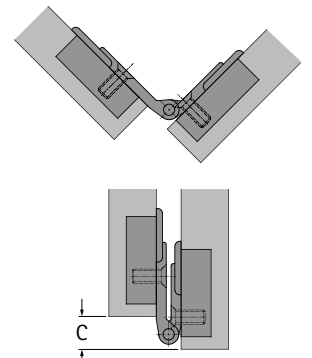
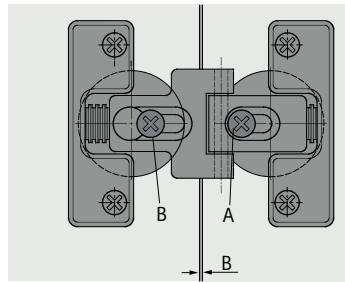
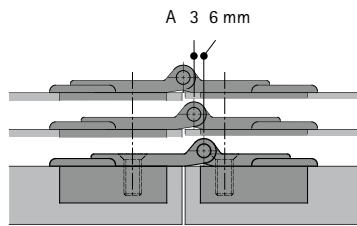
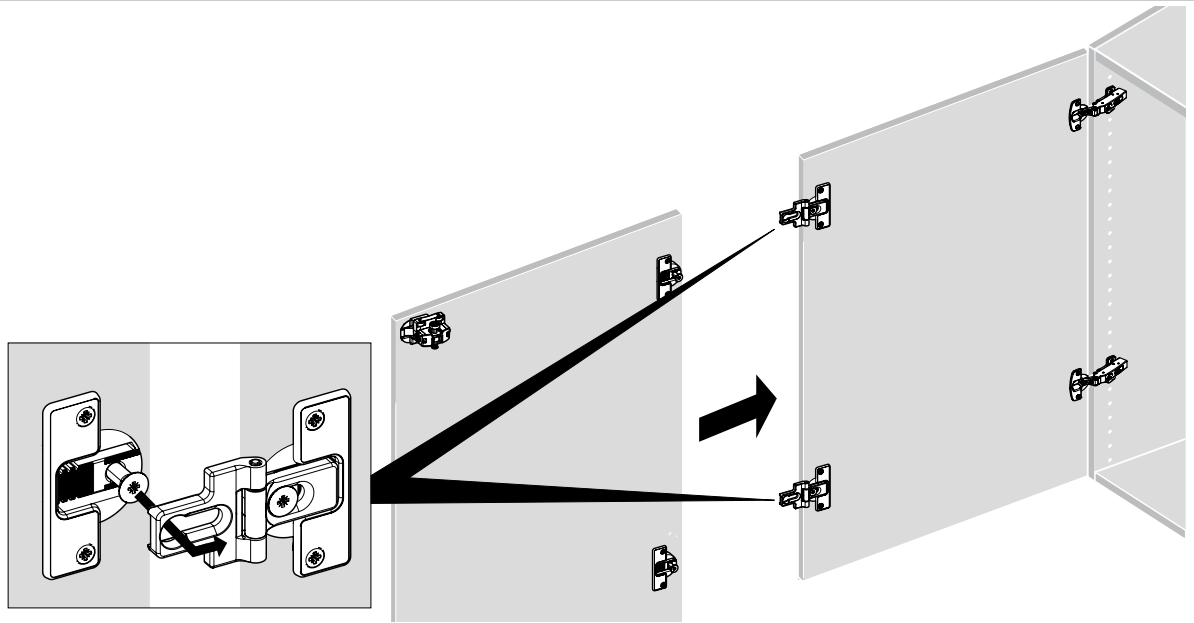

A	C
3	6
6	12

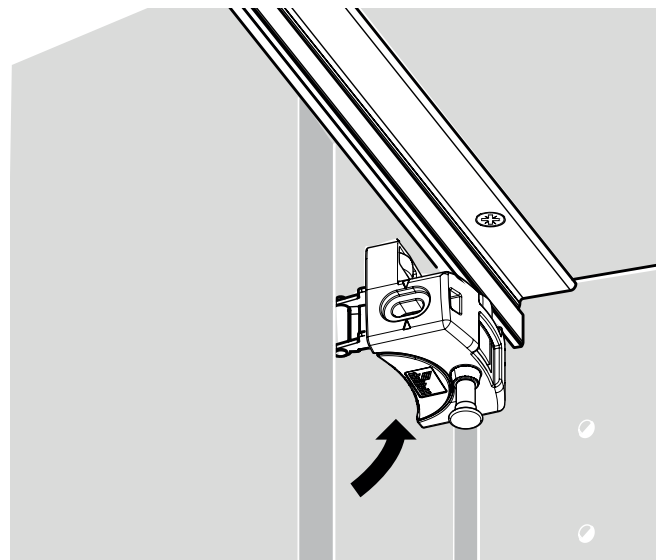
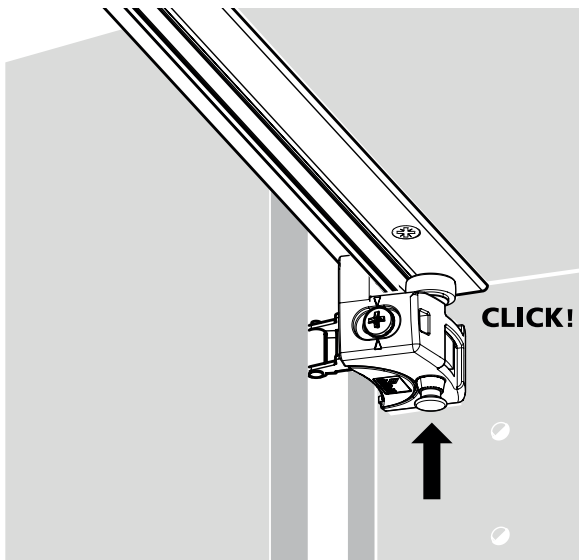

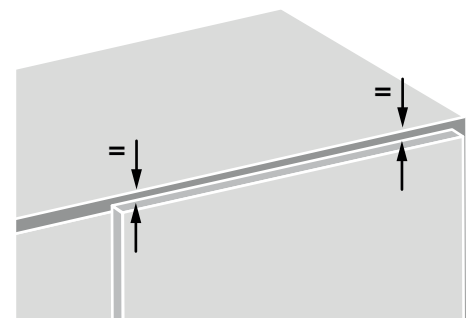
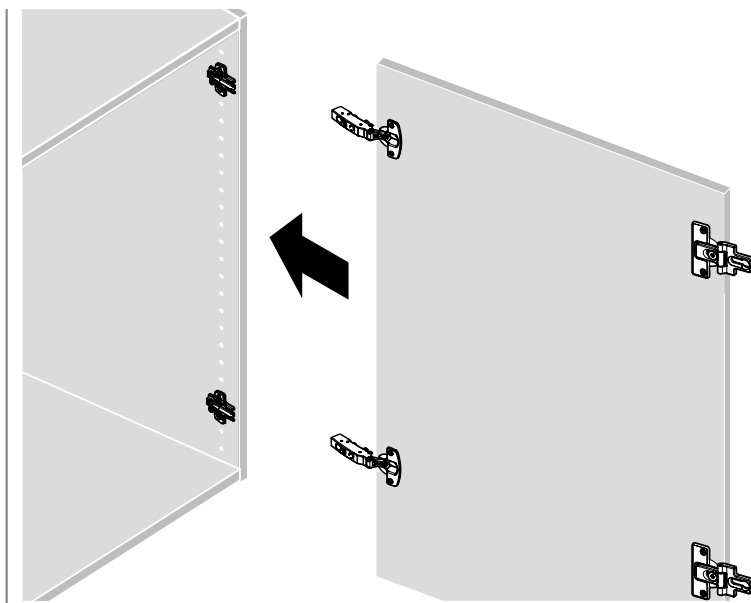
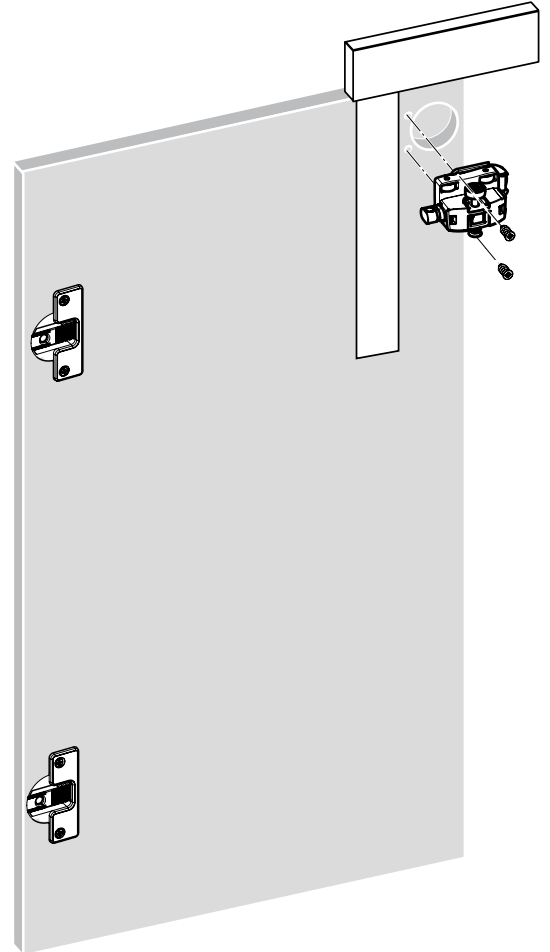
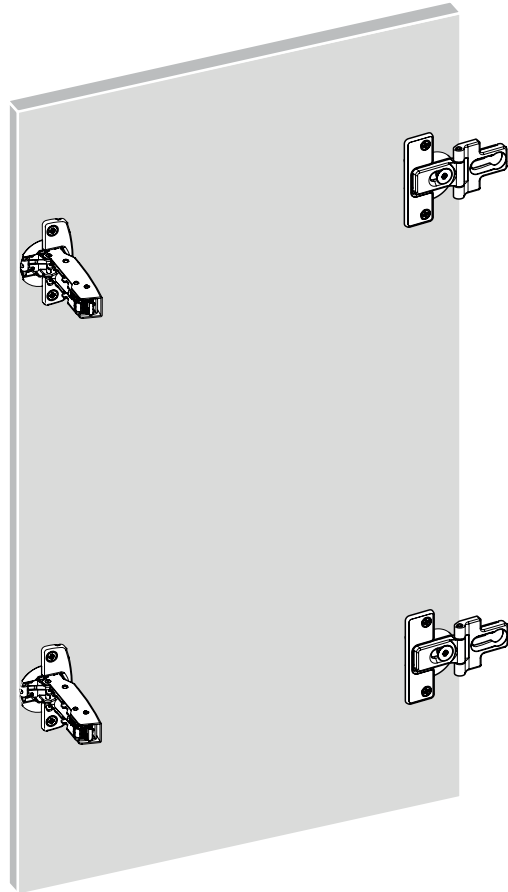
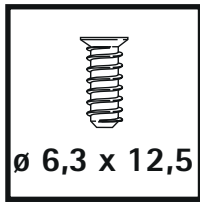
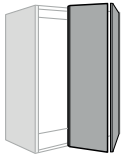

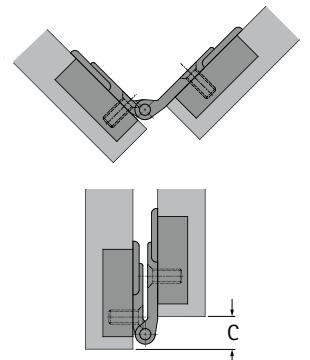
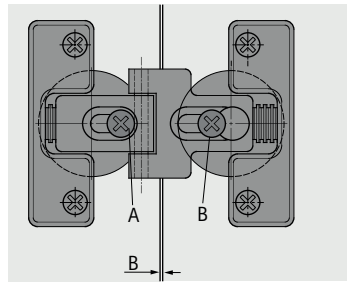
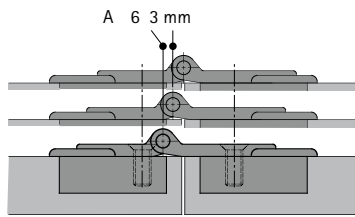
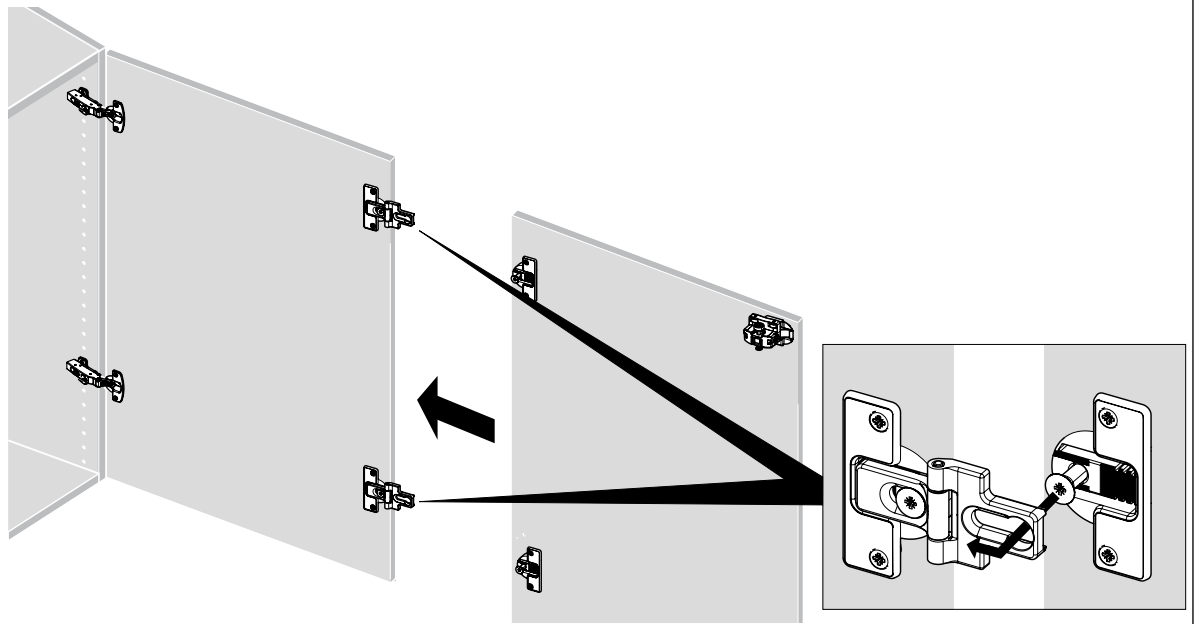

A	C
3	6
6	12

