

TANDEM

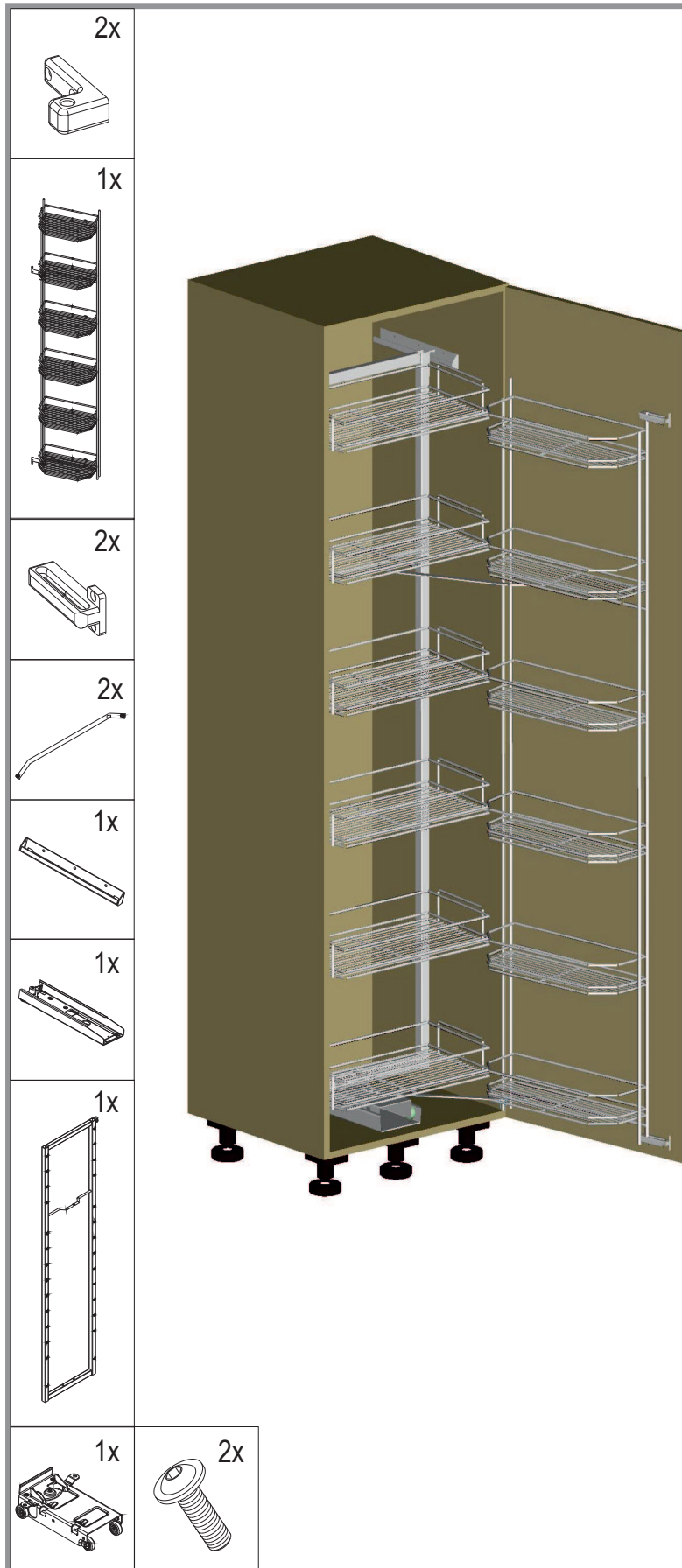

Montageanleitung

TANDEM Schwenkauszug für
45er + 50er Hochschrank

Mounting Instructions

450mm and 500mm
TANDEM swivel pull-out

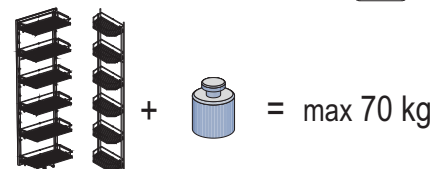
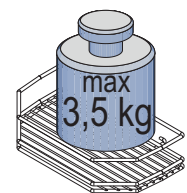
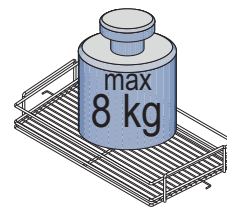

Eigengewicht + Beladung
Empty weight + Load

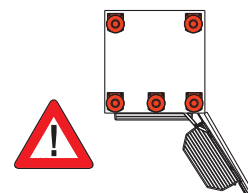

TANDEM

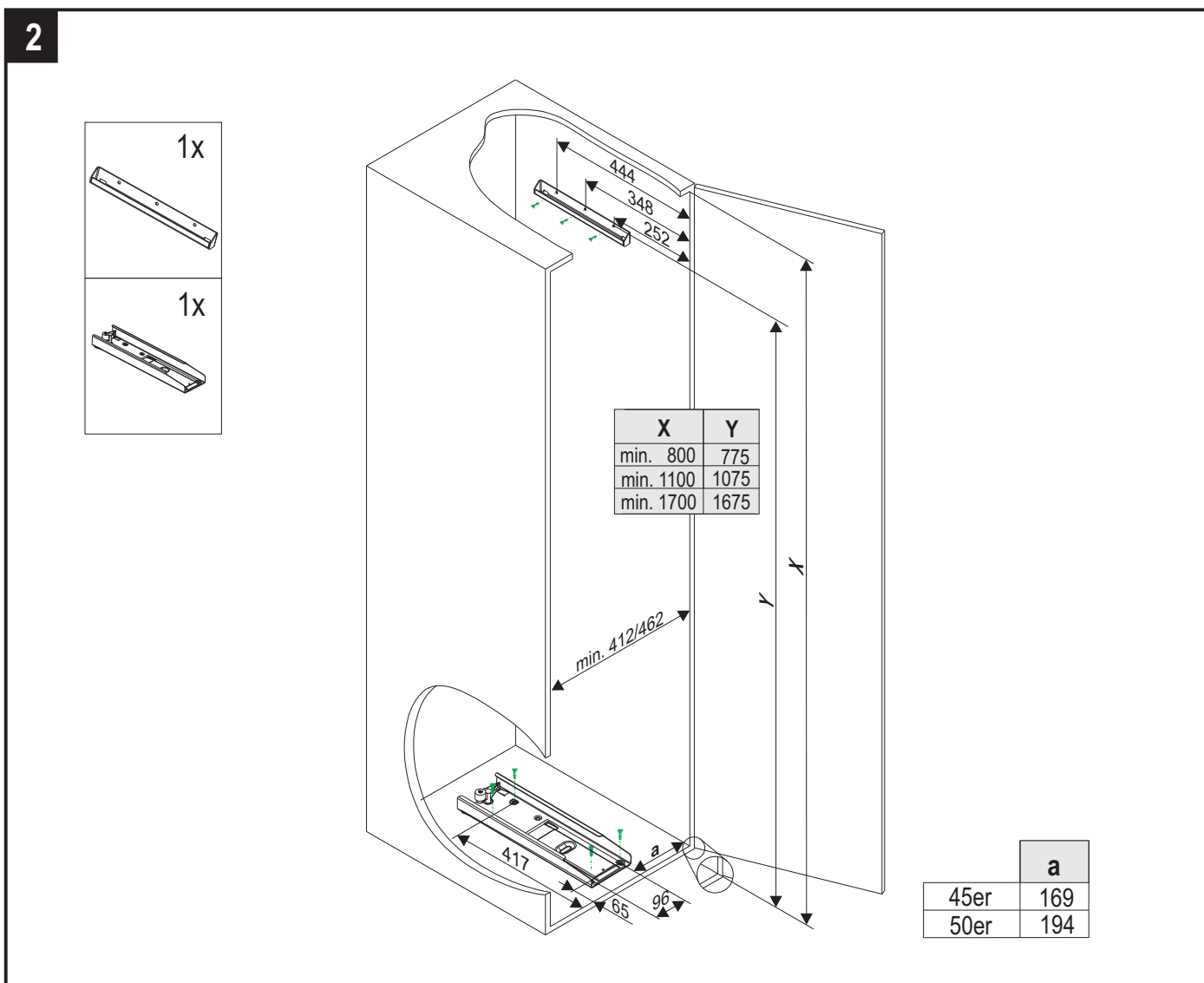
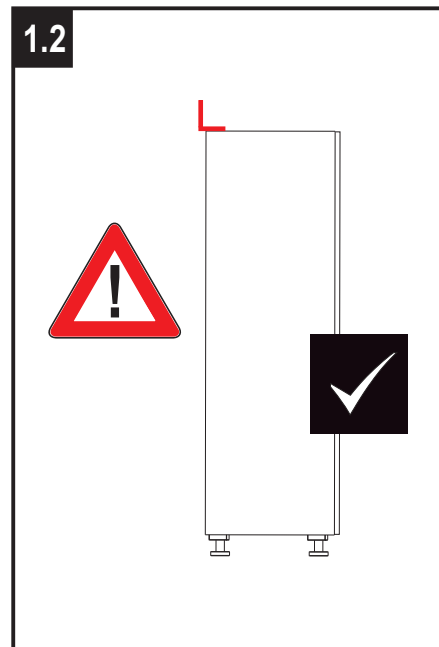
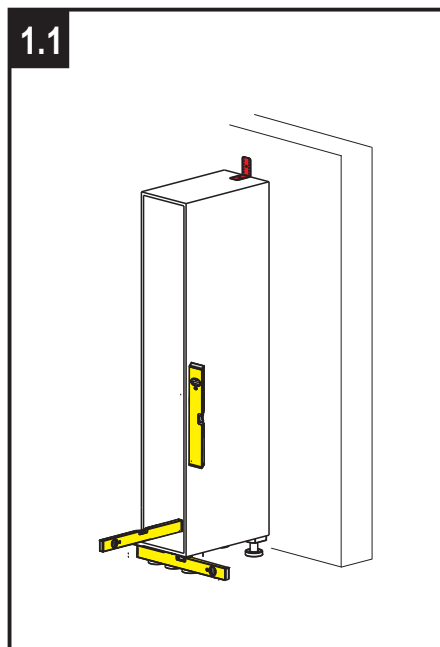
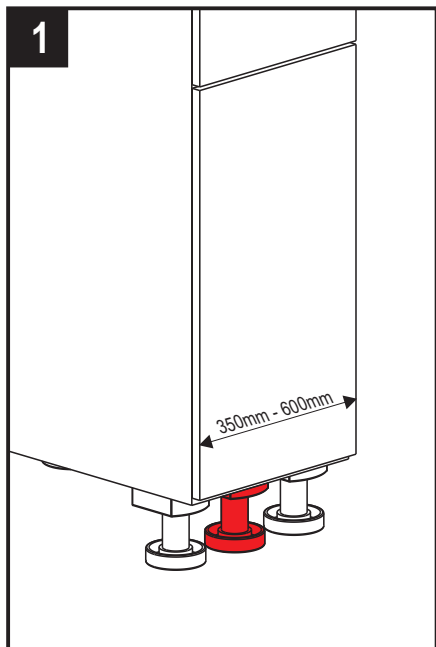

3 Tür rechts
Door right

X	Y
min. 800	625
min. 1100	625
min. 1700	1225

2x

Sollte auf Höhe des oberen Lagers ein Türscharnier montiert sein, so ist das Lager entsprechend tiefer zu montieren
In case of top bearing is in same height as hinge, the bearing is to move to the next possible lower position

4 Tür links
Door left

X	Y
min. 800	625
min. 1100	625
min. 1700	1225

2x

Sollte auf Höhe des oberen Lagers ein Türscharnier montiert sein, so ist das Lager entsprechend tiefer zu montieren
In case of top bearing is in same height as hinge, the bearing is to move to the next possible lower position

5

1x

1x

2x

5mm

6

1.

2.

3.

6.1

6.2

TANDEM

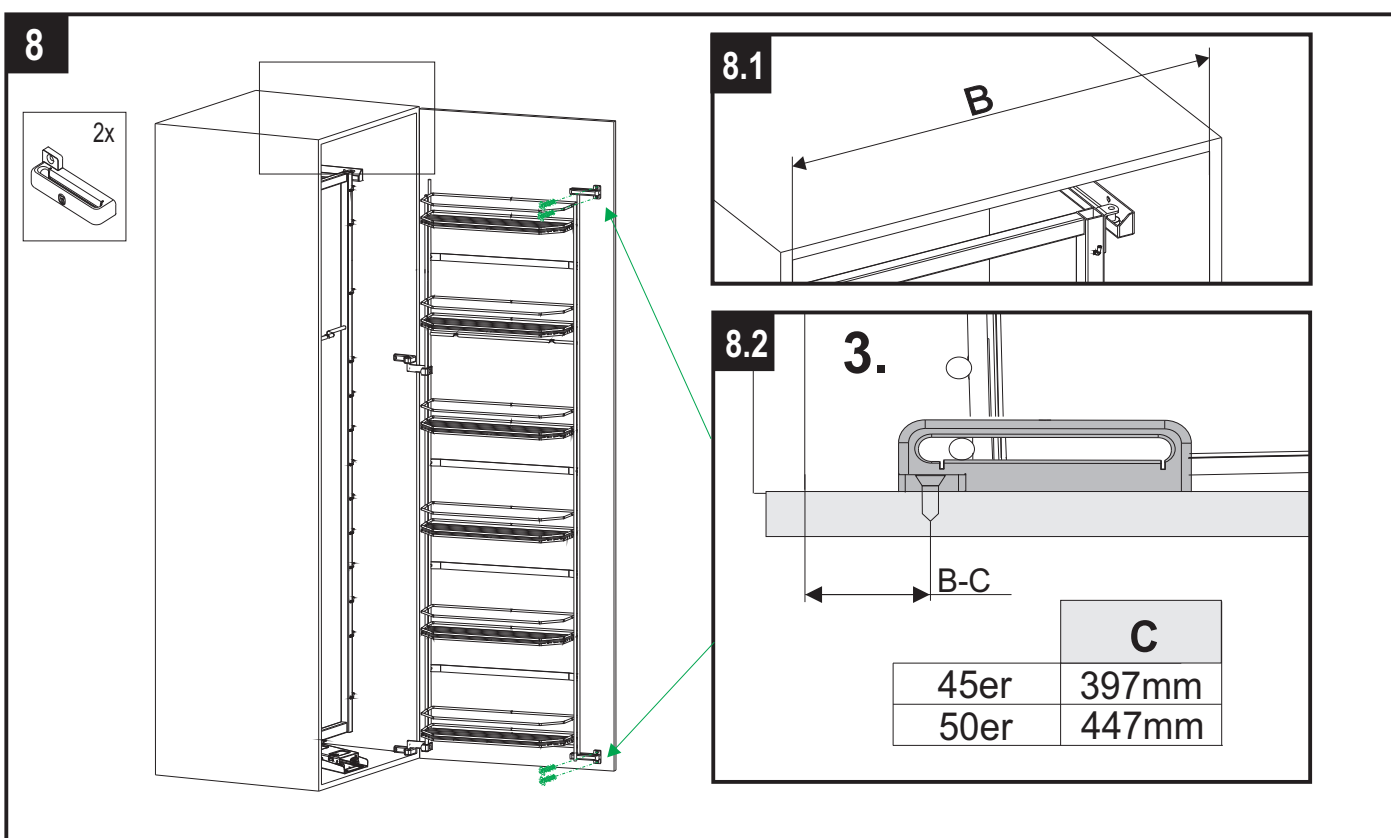
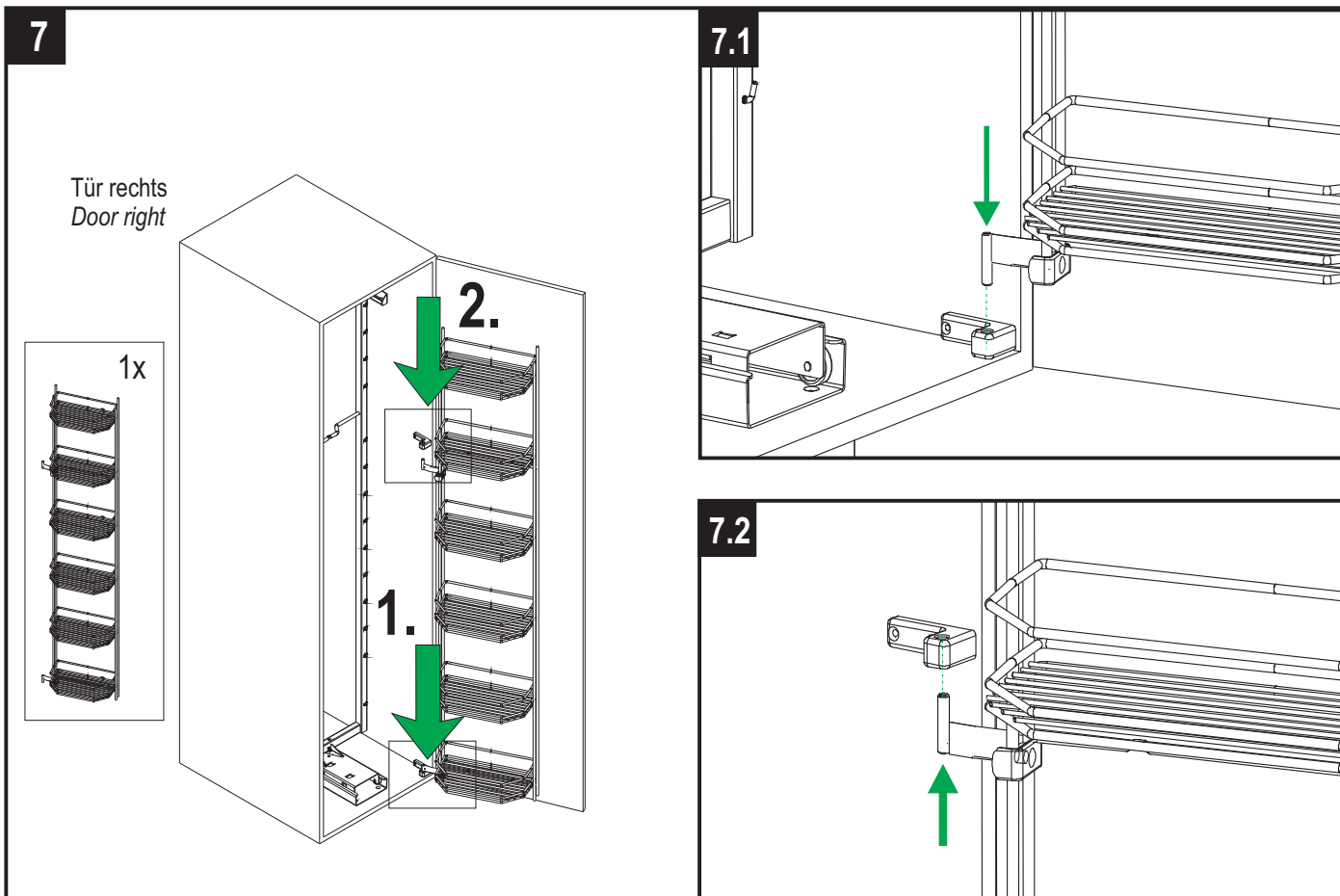

9

Tür links
Door left

Anlieferungszustand für
rechts scharnierte Tür
State at delivery

Links scharnierte Tür
Door left mounted

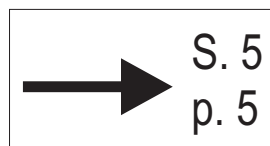
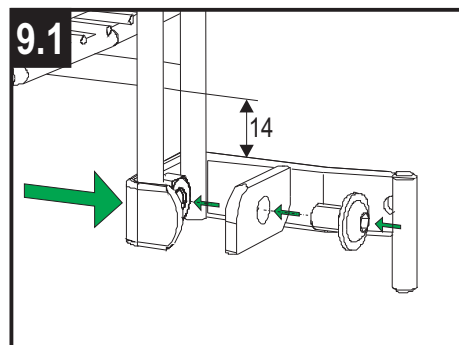
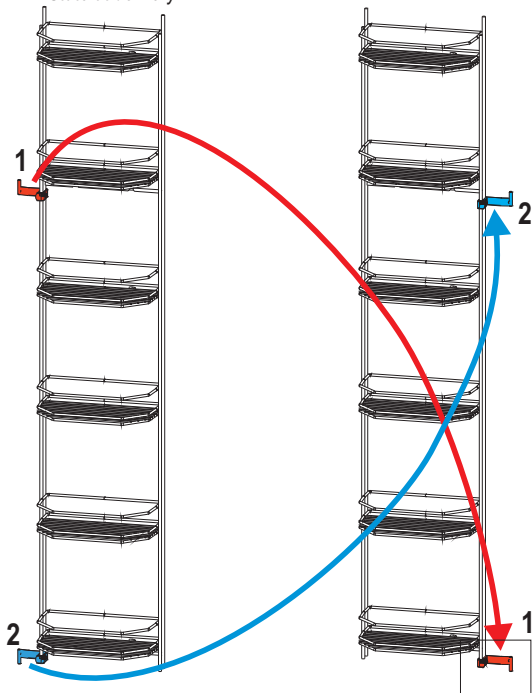

10

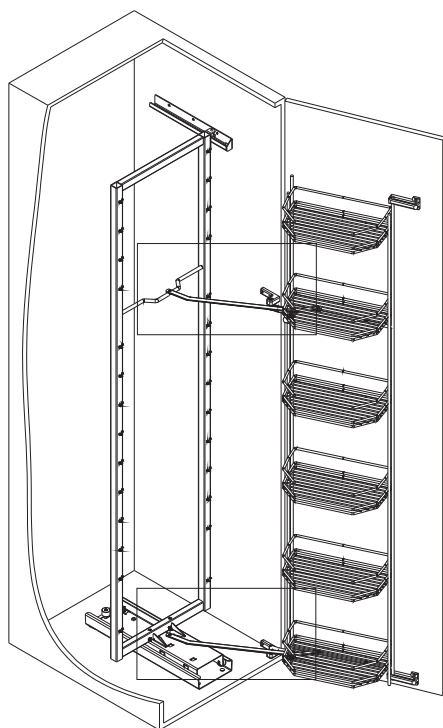
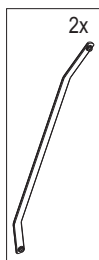

Für links scharnierte Tür spiegelbildlich
For left mounted door mirror image

10.1

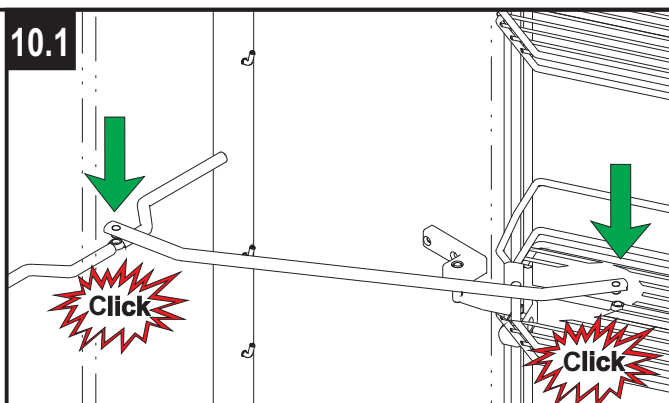

10.2

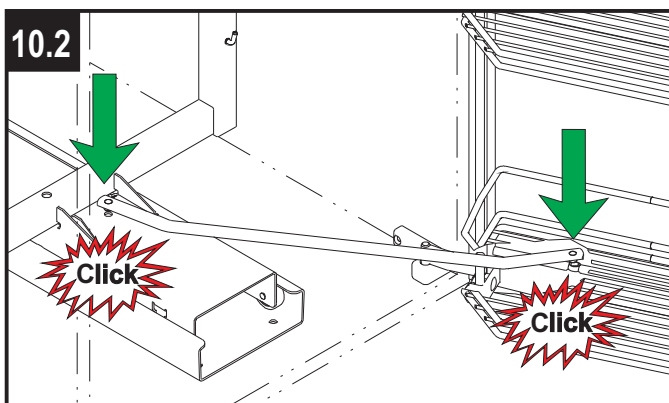

TANDEM



Aufbau als Tandem-Depot
Installation as Chef's Pantry

4x



2x



4x



4x



2x

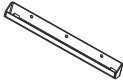

2x

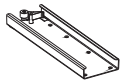

2x

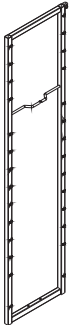

2x

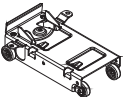

4x
 8x40

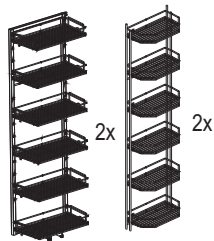
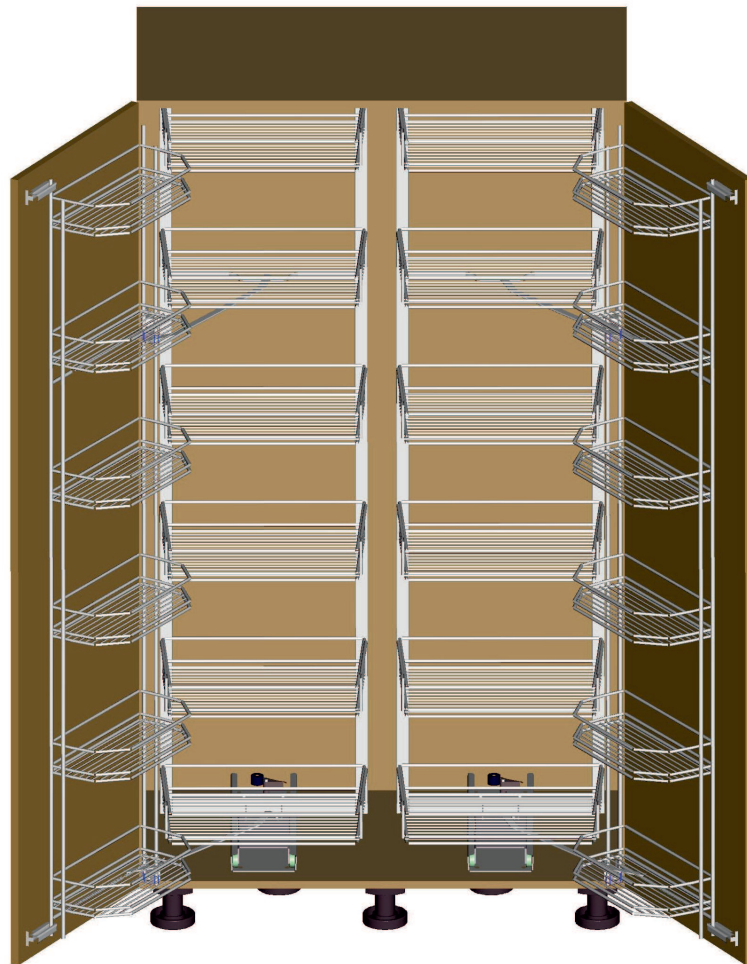

+ = max 100 kg

Eigengewicht + Beladung
 Empty weight + Load

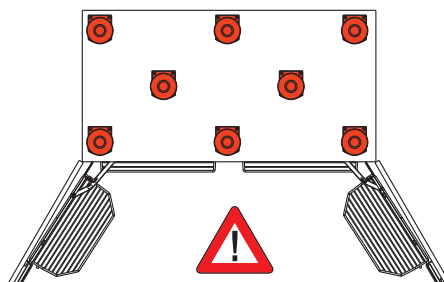
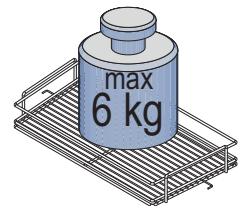
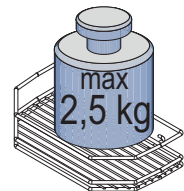

TANDEM

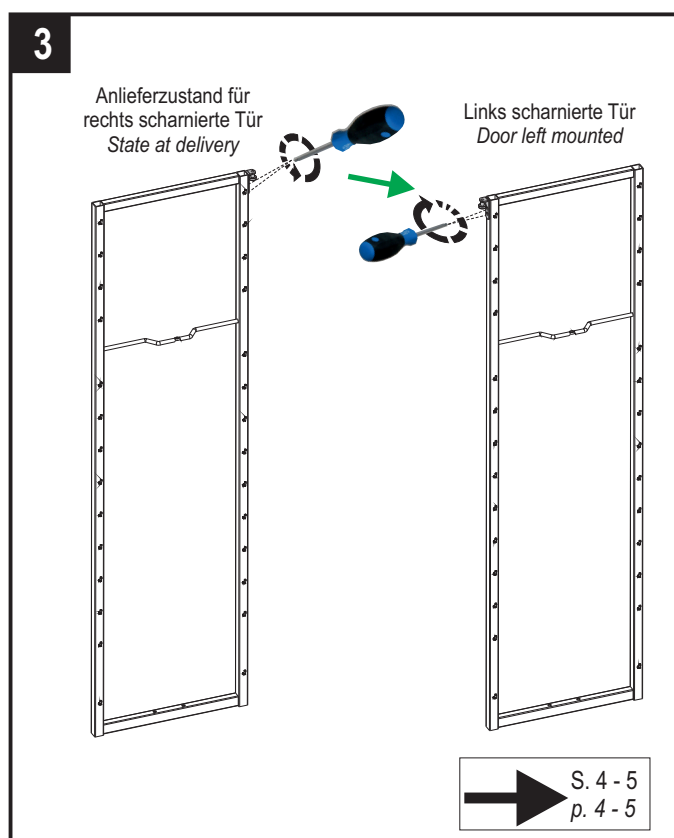
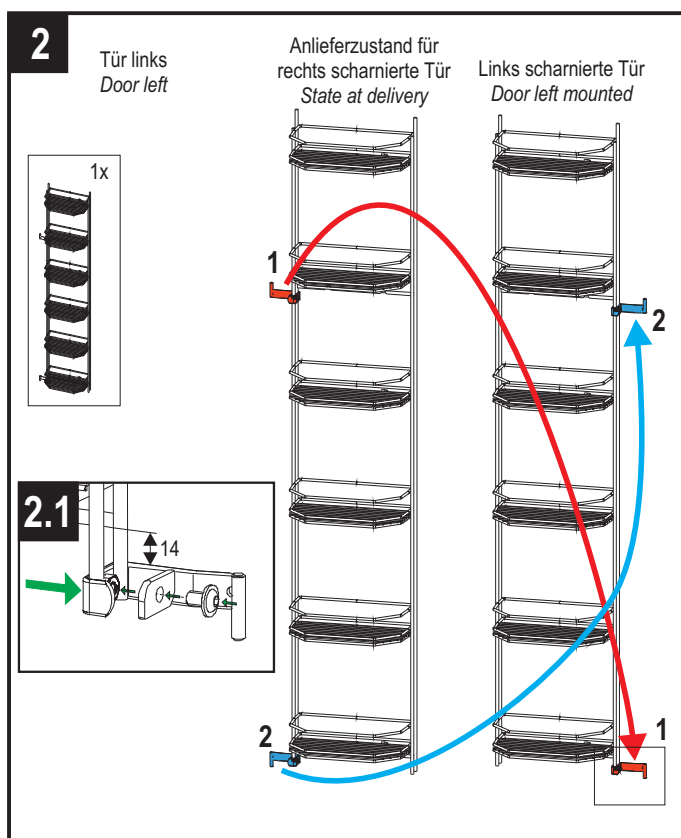
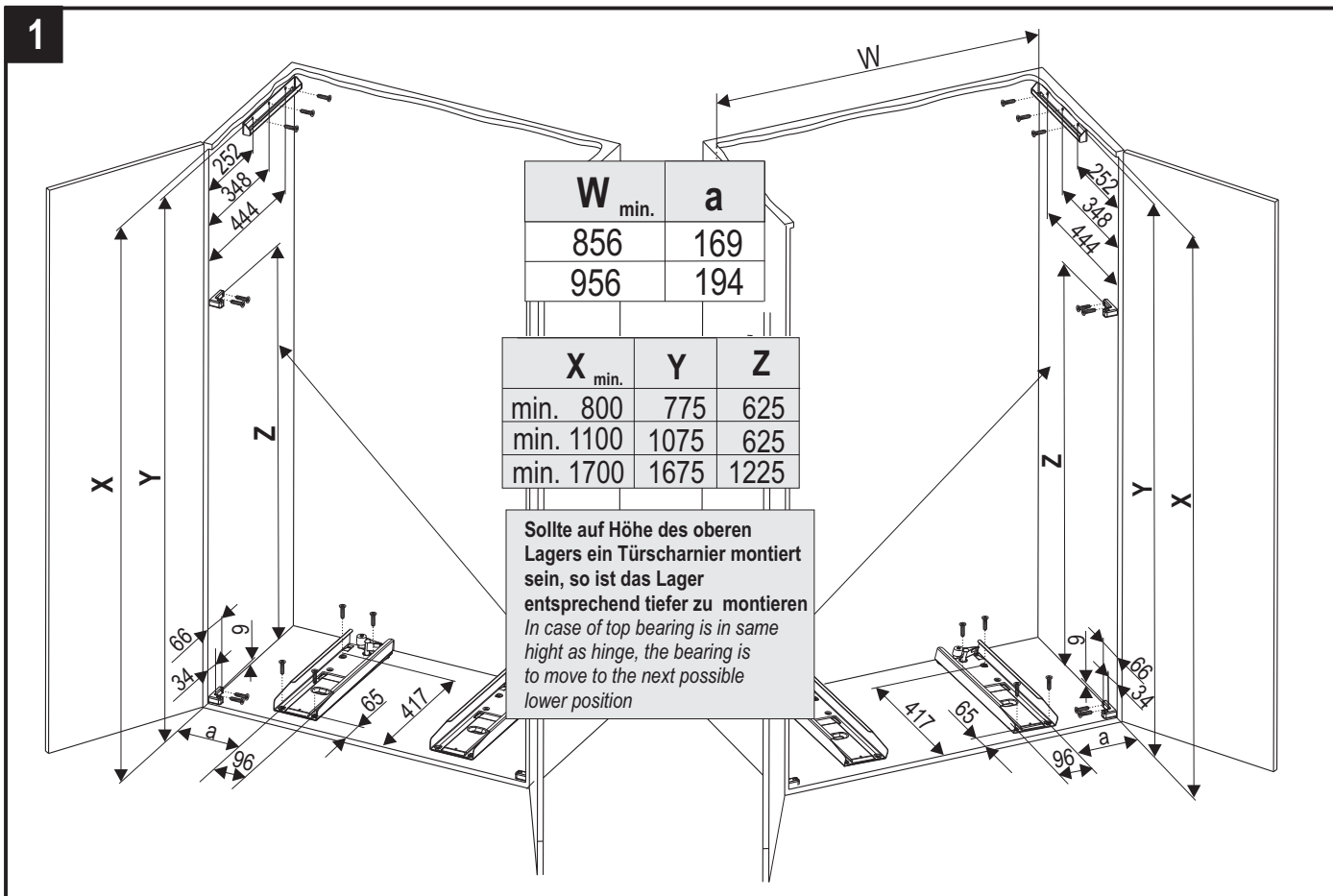

TANDEM

 **KESSEBÖHMER**

2x (3x) 		Montageanleitung TANDEM Schwenkauszug für 60er Hochschrank		
1x 		Mounting Instructions for 600 mm TANDEM swivel pull-out		
2x 				
2x 				
1x 				
1x 				
1x 				
1x 		2x 	 <p>Eigengewicht + Beladung Empty weight + Load</p> 	

TANDEM

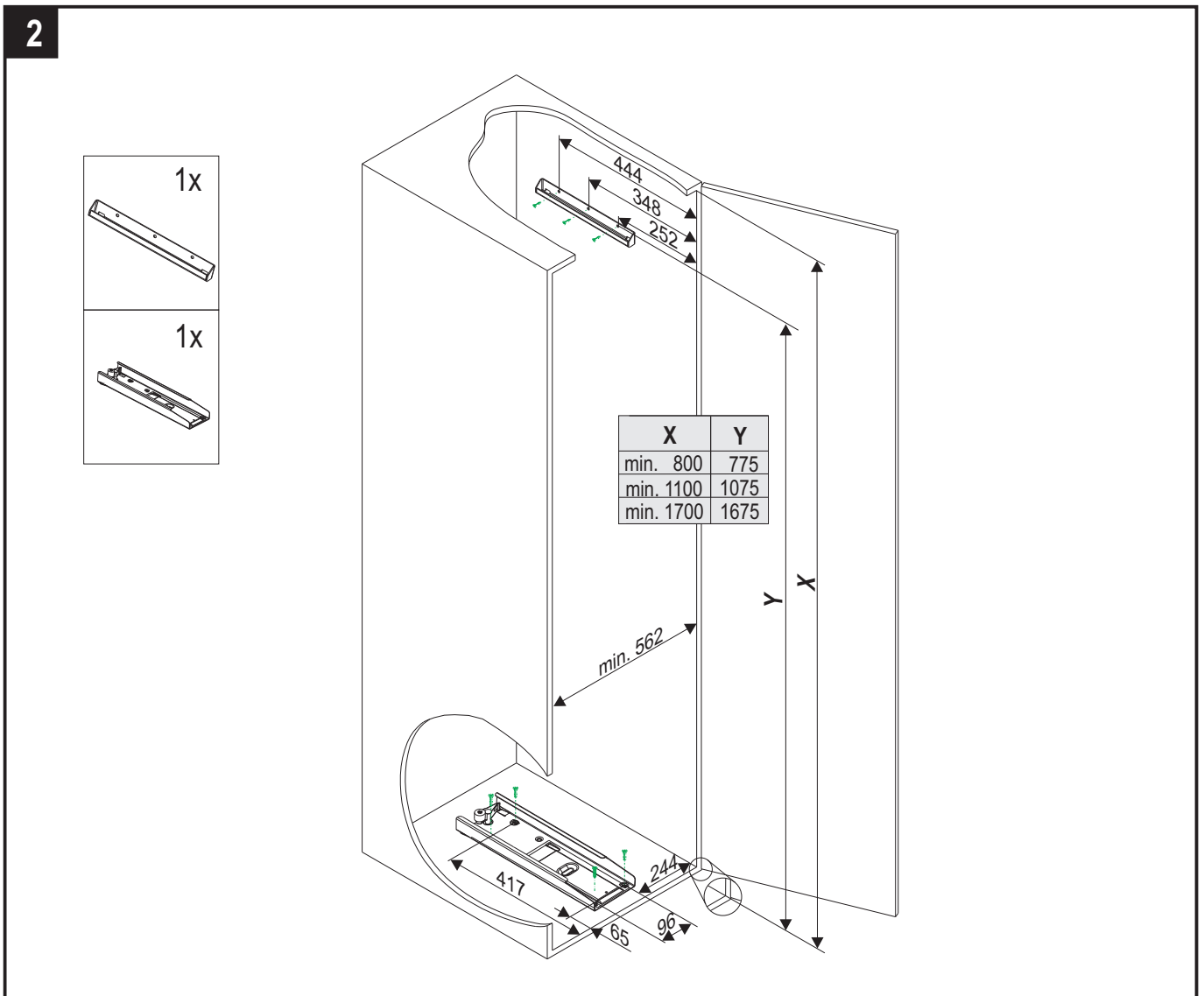
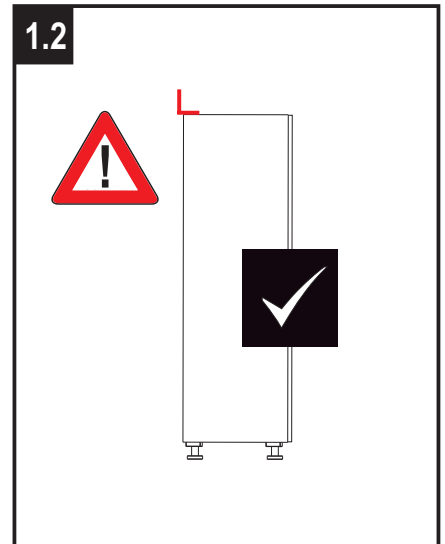
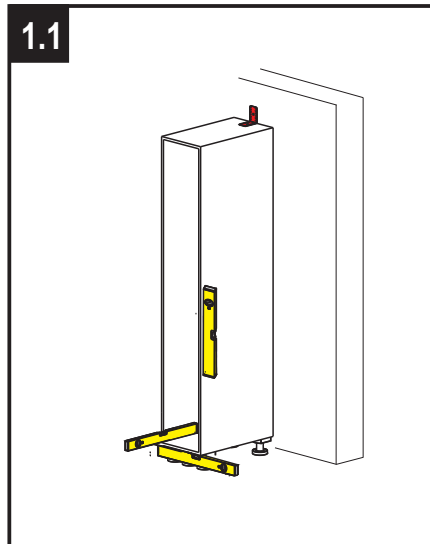
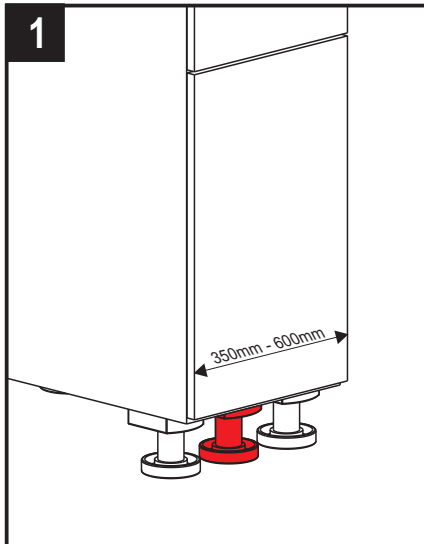

TANDEM



3 Tür rechts
Door right

2x (3x)

optional

Sollte auf Höhe der oberen Lager ein Türscharnier montiert sein, so ist das betroffene Lager entsprechend tiefer zu montieren
In case of top bearings are in same height as hinge, the bearing is to move to the next possible lower position

X	Y	Z
min. 800	625	-
min. 1100	625	815
min. 1700	1225	1415

4 Tür links
Door left

2x (3x)

optional

X	Y	Z
min. 800	625	-
min. 1100	625	815
min. 1700	1225	1415

Sollte auf Höhe der oberen Lager ein Türscharnier montiert sein, so ist das betroffene Lager entsprechend tiefer zu montieren
In case of top bearings are in same height as hinge, the bearing is to move to the next possible lower position

5

1x

1x

2x

5mm

6

1.

2.

3.

6.1

6.2

TANDEM

 **KESSEBÖHMER**

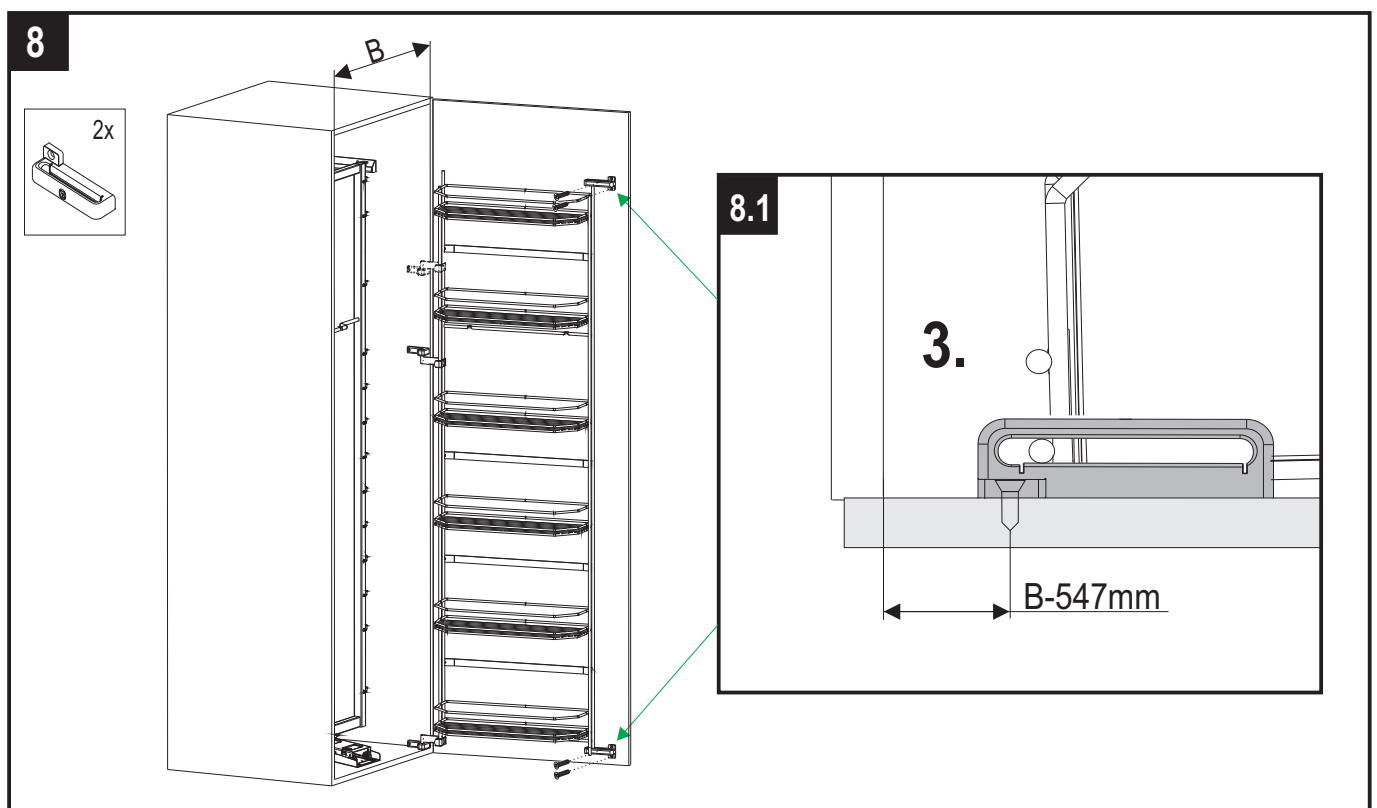
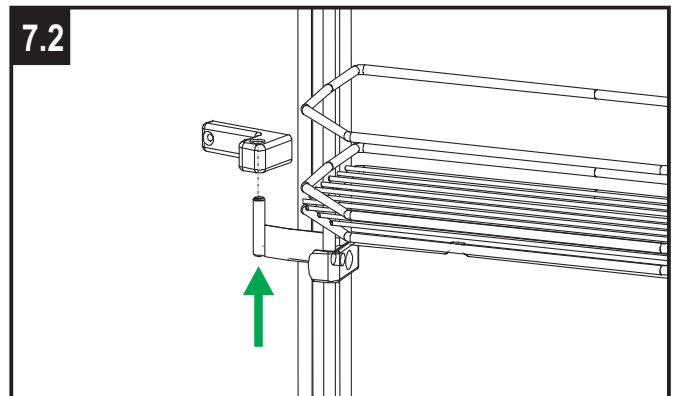
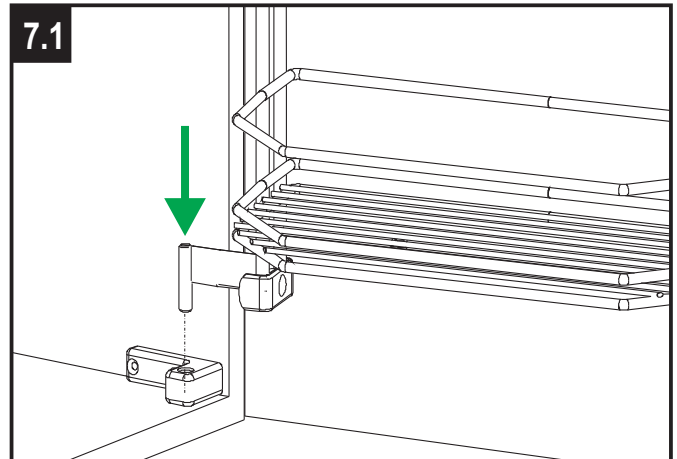
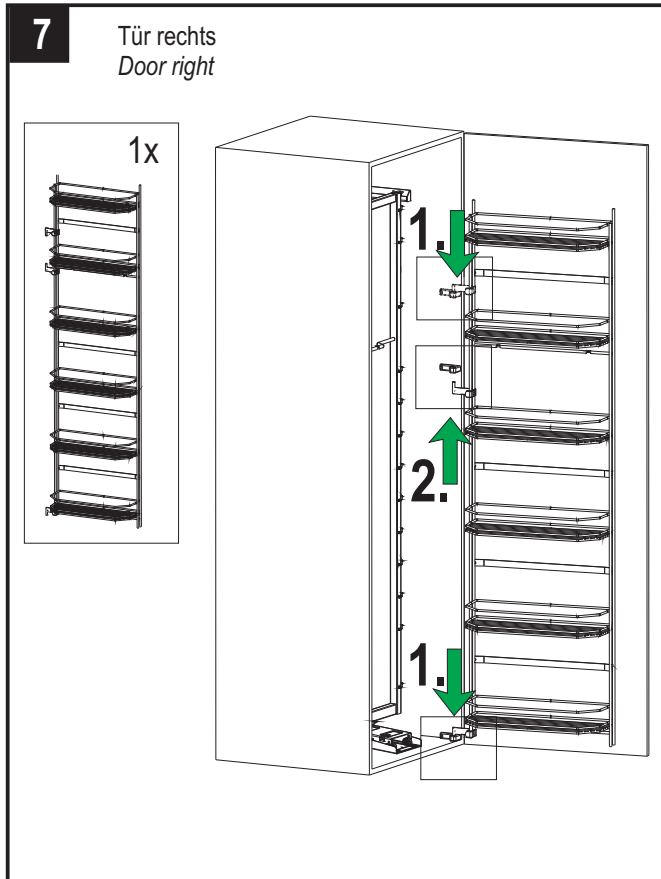

TANDEM

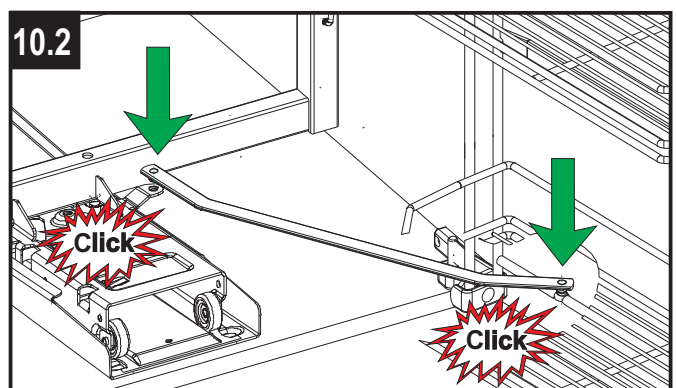
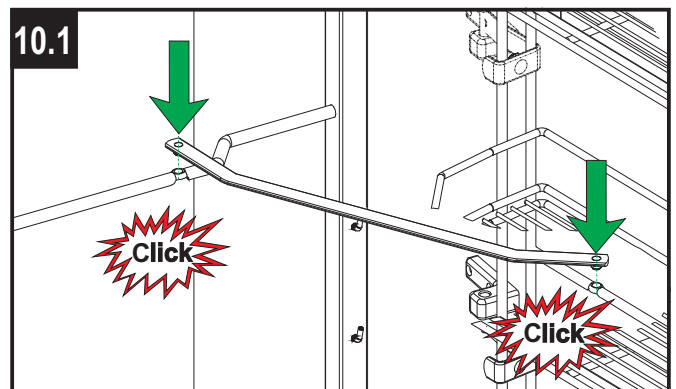
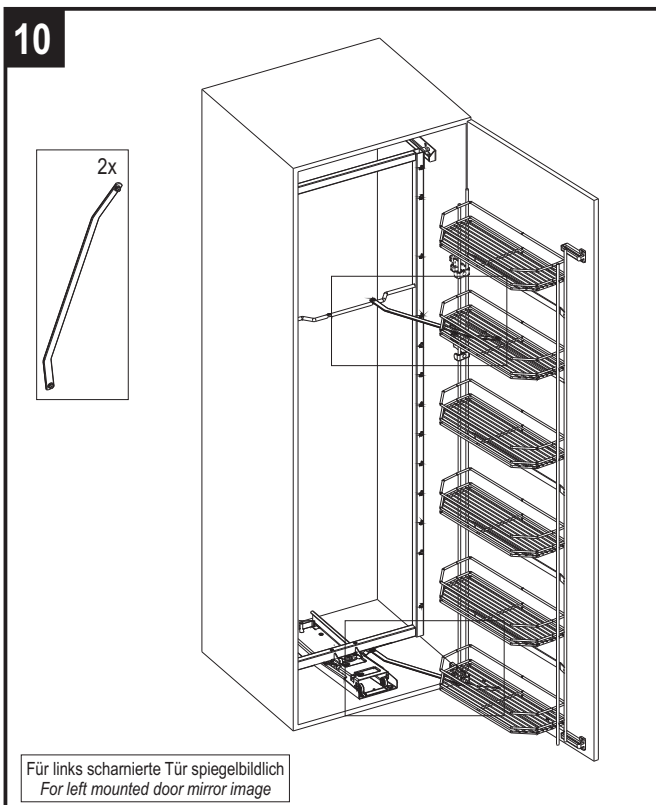
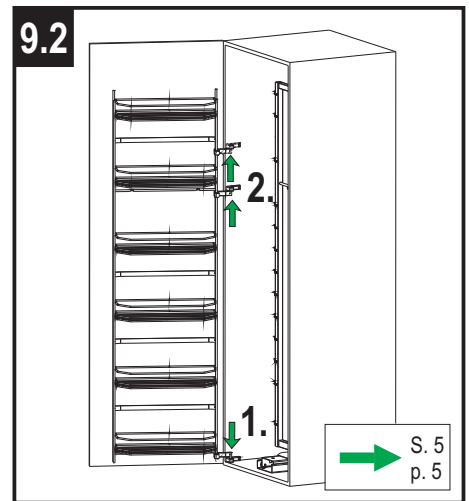
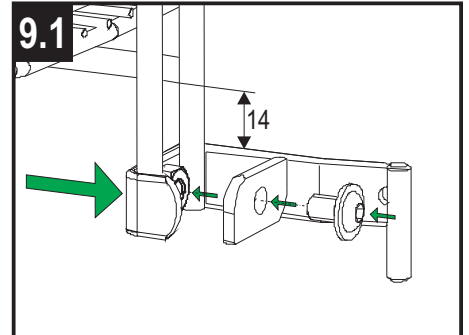
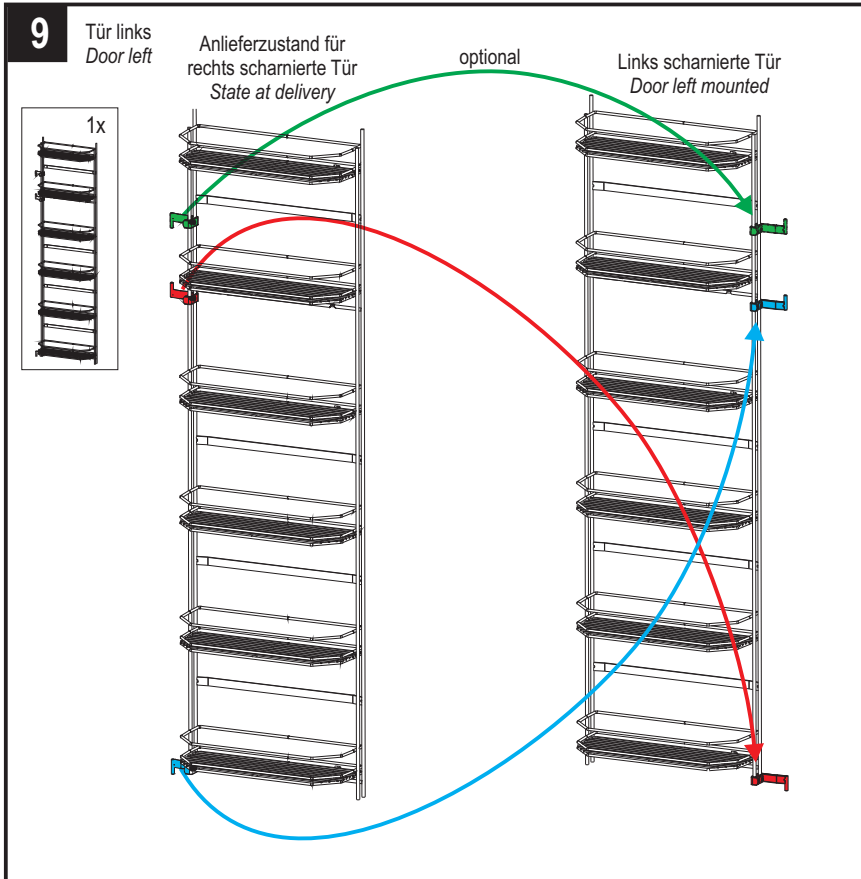

TANDEM

Aufbau als TANDEM Depot
Installation as Chef's Pantry

4x (6x)



2x



4x

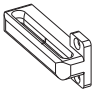

4x



2x

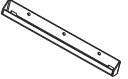

2x

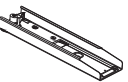

2x

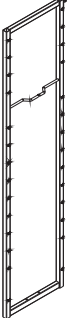

2x

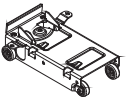

4x

 8x40

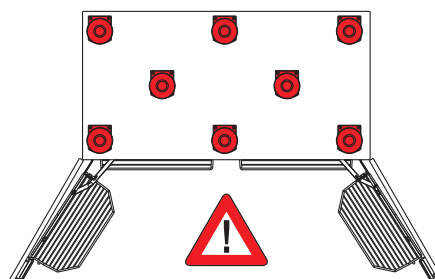
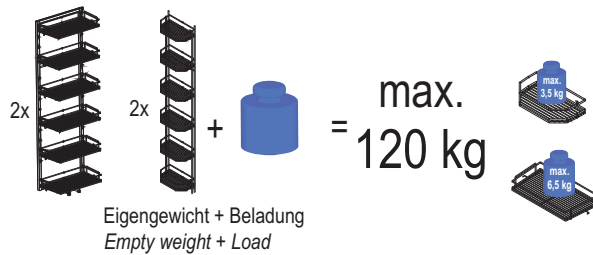
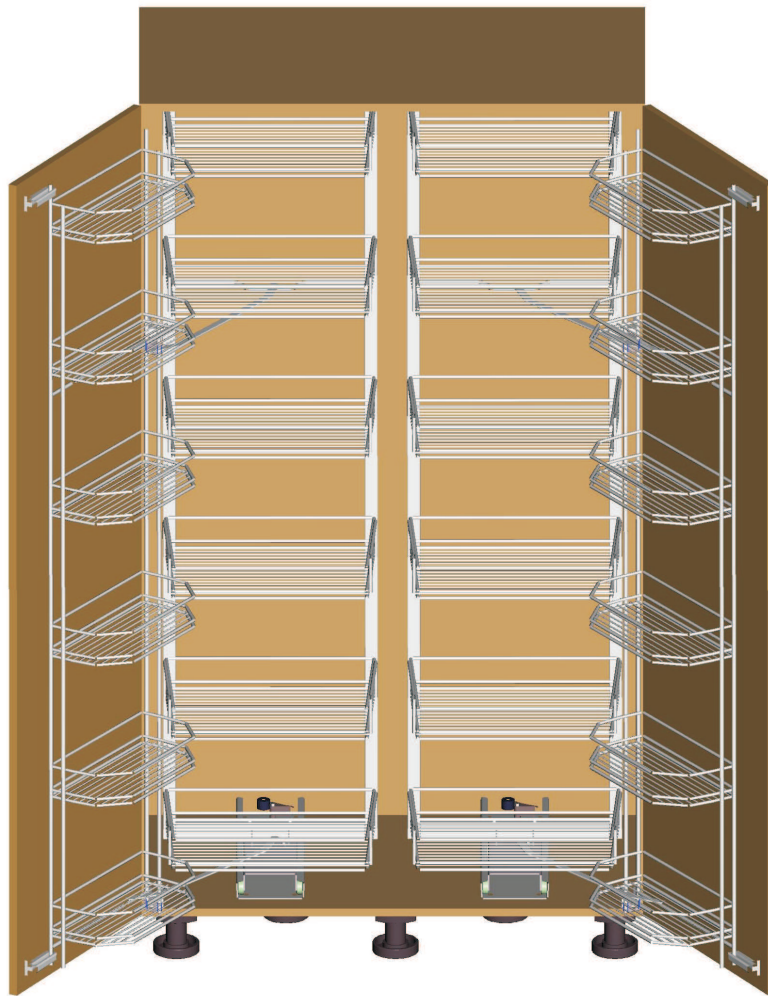

TANDEM

